



Victory

LEISURE HOME
COLLECTION

2020

HOW WE CREATE AMAZING HOMES

From our concept development team – to our aftersales customer care engineers – you can rest assured you're in good hands with Victory Leisure Homes.

DESIGN

From technical designers dedicated to creating clever new layouts and space saving designs, to upholstery and fabric sourcing that makes your leisure home modern and comfortable; our team has every aspect covered down to the finest detail.

BUILD

All of our leisure homes are hand built by skilled craftspeople in our purpose built, energy efficient factory, accredited to ISO45001 Health & Safety Requirements. The production process commences with the steel chassis entering the production line, where the timber support joists and floor are assembled, and then walls and roof are erected to create the shell. The electrical wiring and various insulation materials are then built in, with the exterior cladding fitted later. At the same time, all the internal fixtures and fittings, integrated appliances and plumbing are fitted, and then at the final stages the soft furnishings are added. After numerous quality and safety checks, the leisure home leaves the factory ready for installation on site.

MARKET

Our leisure homes can be purchased through a network of distributors, or directly from holiday parks, where they are used in holiday fleets or sold directly to their new owners. Check our website today to find your local park or distributor.

MAINTAIN

Just like houses, leisure homes need regular maintenance. The owner's handbook, along with the park, will provide a guide to this. In the unlikely event that something goes wrong, our after-sales care team are on hand to help resolve any issues quickly and efficiently under our two-year warranty.

PART OF J. R. RIX & SONS

Victory Leisure Homes is part of J. R. Rix & Sons, a family owned company established in Yorkshire in 1873, regularly appearing in the Times Top Track 250 awards. The group has a diverse portfolio of businesses ranging from shipping and warehousing through to fuel distribution, car retailing, manufacturing and property development.

LIFESTYLE PACK

AVAILABLE

CREATE YOUR OWN

Choose from a wide range of colours and finishes of cladding and uPVC frames, add some outlook doors or maybe even an integrated dishwasher - the choice is yours. See page 23 for more details.

ENERGY EFFICIENCY

Our models all come with extra insulation as standard, but by adding our lifestyle pack you get all the benefits of double glazing with LowE glass and central heating with thermostat.

MODERN CONVENIENCES

Every model has USB ports as standard, plus with the lifestyle pack you also get integrated fridge/freezer and microwave for a flawless kitchen finish.

TAKE A TOUR

Take a virtual tour around all our models on our website at www.victoryleisurehomes.co.uk



SOCOZEEE MATTRESSES

Get a great night's sleep with the premium support, comfort and luxury of our exclusive branded mattress.

PREMIUM BUILD QUALITY

Built to exceed industry standards with energy efficient, hardwearing design that saves you money, reduces your impact on the environment and keeps you warm and safe for many years to come.

See page 24 for construction details.

ROBUST CHASSIS

Our chassis has its own unique robust design, and has extra insulation for energy efficiency as standard on all models in the range.

See page 24 for construction details.

TWO YEAR

WARRANTY

See page 24 for details.

LEISURE HOME COLLECTION

WESTPARK

PAGE 3-6

RIMINI

PAGE 7-10

BELMOR CL

PAGE 11-14

ECHO

PAGE 15-18

ATLANTIC

PAGE 19-22

Customising Your Unique Home

PAGE 23

Range Specifications

PAGE 23

Two Year Warranty

PAGE 24

Constructing Quality Homes

PAGE 24

Measurements

PAGE 25

Important Information

PAGE 25

The Lodge Collection

PAGE 26



PREMIUM BUILD QUALITY

Artefoam high performance external cladding
Vaulted ceilings throughout
Steel pantile peaked insulated roof
Winter additional floor insulation
Galvanised corner steadies & tow bar with front and rear use
External light
LED lamps to most light fittings
Carpet underlay

HOMELY LIVING AREA

Bluetooth music system
Coffee table
Modern electric fire
Voile curtains to most windows
Sofa pull out bed
Colour co-ordinated lounge scatter cushions
USB charging points
Sliding patio door to front

KITCHEN/DINER

Integrated dishwasher
Oven and 5 burner hob
Externally vented cooker hood with light
Free standing under counter fridge
Panoramic outlook to dinette area

SPACIOUS BATHROOMS

Basin with vanity unit
Built in shower cubicle
Close-coupled ceramic toilet with dual flush
Bathroom fan

LUXURIOUS BEDROOMS

TV point in bedrooms 1 and 2
USB charging points
6'3" long beds in bedroom 2
SoCozeee mattresses

LIFESTYLE PACK (OPTIONAL)

uPVC double glazing with Low-E glass
Combi boiler central heating with room thermostat control
Integrated fridge/freezer
Integrated microwave

POPULAR OPTIONAL EXTRAS

Environmental exterior with colour co-ordinated
uPVC windows & doors
Fully galvanised or pre-galvanised chassis
Choice of external claddings in various colours
Integrated washing machine

MORE ONLINE!

Read the full specification
and take a virtual tour online
www.victoryleisurehomes.co.uk

LIFESTYLE PACK

AVAILABLE



WESTPARK LAYOUTS

For symbol key see page 24



▲ WESTPARK 39, 2 BEDROOMS



▲ WESTPARK 41, 3 BEDROOMS





RIMINI

SPACIOUS AND STYLISH

- ▶ A modern adaptation of the galley kitchen layout
- ▶ Stylish open plan living/dining area
- ▶ Freestanding armchairs
- ▶ Modern high gloss kitchen
- ▶ King size bed in master bedroom and 2'6" wide beds in bedroom 2

PREMIUM BUILD QUALITY

Vaulted ceilings throughout
Steel pantile peaked insulated roof
Winter additional floor insulation
Galvanised corner steadies & tow bar with front and rear use
External light
LED lamps to most light fittings
Carpet underlay

OPEN PLAN LIVING AREA

Modern electric fire
Coffee table
Voile curtains to most windows
Sofa pull out bed
Colour co-ordinated cushions
USB charging points

HIGH GLOSS STUDIO KITCHEN

High level oven
Hob and externally vented cooker hood with light
Freestanding under counter fridge

SPACIOUS FAMILY BATHROOM

Basin with vanity unit
Built in shower cubicle
Close-coupled ceramic toilet with dual flush
Bathroom fan

COMFORTABLE BEDROOMS

TV point in bedrooms 1 and 2
USB charging points
SoCozeeee mattresses
King size bed to master bedroom
6'3" x 2'6" beds to bedroom 2

LIFESTYLE PACK (OPTIONAL)

uPVC double glazing with Low-E glass
Combi boiler central heating with room thermostat control
Integrated fridge/freezer
Integrated microwave

POPULAR OPTIONAL EXTRAS

Environmental exterior with colour co-ordinated
uPVC windows & doors
Fully galvanised or pre-galvanised chassis
Choice of external claddings in various colours
Opening outlook doors

MORE ONLINE!

Read the full specification
and take a virtual tour online
www.victoryleisurehomes.co.uk

LIFESTYLE PACK

AVAILABLE



RIMINI LAYOUTS

For symbol key see page 24



▲ RIMINI 36, 2 BEDROOMS

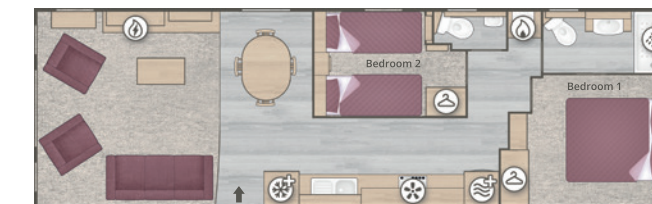

▲ RIMINI 38, 2 BEDROOMS

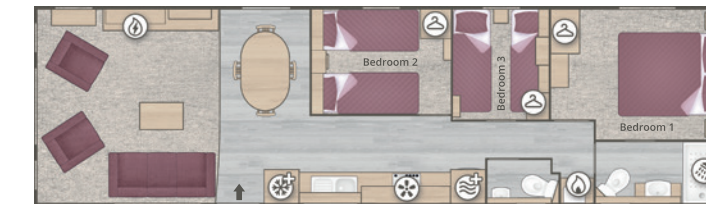

▲ RIMINI 41, 3 BEDROOMS





BELMOR CENTRE LOUNGE

DESIGNED WITH FAMILIES IN MIND

- ▶ Bedrooms at both ends - ideal for families or sharing
- ▶ Shower room at both ends
- ▶ Panoramic view in dining area
- ▶ King size bed in master bedroom and longer 6'3" beds in twin bedrooms



PREMIUM BUILD QUALITY

Vaulted ceilings throughout
Steel pantile peaked insulated roof
Winter additional floor insulation
Galvanised corner steadies & tow bar
with front and rear use
External light
LED lamps to most light fittings
Carpet underlay

CENTRAL LIVING AREA

Modern electric fire
Coffee table
Voile curtains to most windows
Colour co-ordinated cushions
USB charging point
Opening outlook doors
Sofa pull out bed

MODERN KITCHEN

Cooker & externally vented cooker hood with light
Free standing under counter fridge

TWO BATHROOMS

Basin with vanity unit
Built in shower cubicle
Close-coupled ceramic toilet with dual flush
Bathroom fan

RELAXING BEDROOMS

King size bed to master bedroom
6'3" long beds in bedroom 2 and 3
TV point to bedroom 1 and 2
USB charging points

LIFESTYLE PACK (OPTIONAL)

uPVC double glazing with Low-E glass
Combi boiler central heating
with room thermostat control
Integrated fridge/freezer
Integrated microwave

POPULAR OPTIONAL EXTRAS

Environmental exterior with colour co-ordinated
uPVC windows & doors
Fully galvanised or pre-galvanised chassis
Choice of external claddings in various colours

MORE ONLINE!

Read the full specification
and take a virtual tour online
www.victoryleisurehomes.co.uk

LIFESTYLE PACK

AVAILABLE



BELMOR CL LAYOUTS

For symbol key see page 24

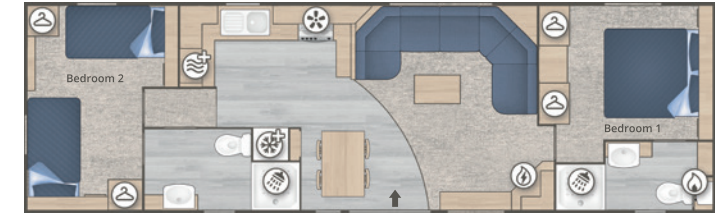

▲ BELMOR CL 39, 2 BEDROOMS

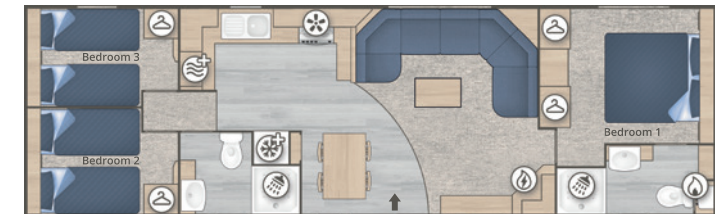

▲ BELMOR CL 39, 3 BEDROOMS





PREMIUM BUILD QUALITY

Vaulted ceilings throughout
Steel pantile peaked insulated roof
Winter additional floor insulation
Galvanised corner steadies & tow bar with front and rear use
LED lamps to most light fittings
External light
Carpet underlay

COSY LIVING AREA

Panoramic front aspect
Generous lounge seating area
Sofa pull out bed
Separate armchair (except 28' model)
Colour co-ordinated cushions
Modern electric fire
Coffee table
Voile curtains to most windows
USB charging point

SEMI-ENCLOSED KITCHEN/DINER

Cooker & externally vented cooker hood with light
Free standing under counter fridge

SPACIOUS FAMILY BATHROOM

Basin with vanity unit
Built in shower cubicle
Full size bath with fitted shower (38-2 model only)
Close-coupled ceramic toilet with dual flush
Bathroom fan

COMFORTABLE BEDROOMS

TV point to bedrooms 1 and 2
USB charging points
Longer beds in bedroom 2 – now 6'3" in length

LIFESTYLE PACK (OPTIONAL)

uPVC double glazing with Low-E glass
Combi boiler central heating with room thermostat control
Integrated fridge/freezer
Integrated microwave

POPULAR OPTIONAL EXTRAS

Environmental exterior with colour co-ordinated
uPVC windows & doors
Fully galvanised or pre-galvanised chassis
Choice of external claddings in various colours
Opening outlook doors

MORE ONLINE!

Read the full specification
and take a virtual tour online
www.victoryleisurehomes.co.uk

LIFESTYLE PACK

AVAILABLE



ECHO LAYOUTS

For symbol key see page 24



▲ ECHO 28, 2 BEDROOMS



▲ ECHO 33, 2 BEDROOMS



▲ ECHO 36, 2 BEDROOMS



▲ ECHO 36, 3 BEDROOMS



▲ ECHO 38, 2 BEDROOMS



▲ ECHO 39, 3 BEDROOMS



ATLANTIC

GREAT VALUE, EXPERT QUALITY

- ▶ Robust build for family holidays
- ▶ Versatile open plan layout
- ▶ Generous seating area
- ▶ Panoramic views
- ▶ Blue feature seating in dining area

PREMIUM BUILD QUALITY

Vaulted ceilings throughout
Steel pantile peaked insulated roof
Winter additional floor insulation
Galvanised corner steadies & tow bar
with front and rear use
LED lamps to most light fittings
External light

GREAT FAMILY LIVING AREA

Generous seating area
Colour co-ordinated cushions
Coffee table
Modern electric fire
Voile curtains to most windows
USB charging point
Sofa pull out bed

SPACIOUS KITCHEN/DINER

Fixed dinette seating area with bench seat (except 28')
Cooker & externally vented cooker hood with light

FAMILY BATHROOM

Built in shower cubicle
Basin with high gloss cupboard below
Close-coupled ceramic toilet with dual flush
Bathroom fan

COMFORTABLE BEDROOMS

TV point in master bedroom
USB charging points
6'3" long beds in bedroom 2

LIFESTYLE PACK (OPTIONAL)

uPVC double glazing with Low-E glass
Combi boiler central heating
with room thermostat control
Integrated fridge/freezer
Integrated microwave

POPULAR OPTIONAL EXTRAS

Fully galvanised or pre-galvanised chassis
Environmental exterior with colour co-ordinated
uPVC windows & doors
Opening outlook doors

MORE ONLINE!

Read the full specification
and take a virtual tour online
www.victoryleisurehomes.co.uk

LIFESTYLE PACK

AVAILABLE



ATLANTIC LAYOUTS

For symbol key see page 24



▲ ATLANTIC 28, 2 BEDROOMS



▲ ATLANTIC 32, 2 BEDROOMS



▲ ATLANTIC 36, 2 BEDROOMS



▲ ATLANTIC 38, 3 BEDROOMS

CUSTOMISING YOUR UNIQUE HOME

With Victory, you can personalise any model to create a leisure home that really is unique to you. Many of our models have extra features as standard, so please check your standard specification before deciding which of the options below to add to your design.

- ▶ Lifestyle pack
 - ▶ Combi boiler central heating with thermostat control
 - ▶ uPVC double glazing with Low-E glass
 - ▶ Integrated fridge/freezer
 - ▶ Integrated microwave
- ▶ Outlook front doors
- ▶ Choice of external claddings & matching windows
- ▶ Fully galvanised chassis
- ▶ Pre-galvanised chassis
- ▶ Integrated dishwasher*
- ▶ Integrated washing machine*
- ▶ SoCozeeee Mattresses (Atlantic range only)
- ▶ Bedding sets
- ▶ Space saving fold-under bed to any twin bedroom**

*Not available in some models where layout does not allow.
**Not in conjunction with the SoCozeeee mattress.

SPECIFICATIONS

A HANDY CHECKLIST OF STANDARD AND OPTIONAL LEISURE HOME FEATURES

FEATURE	WESTPARK	RIMINI	BELMOR CL	ECHO	ATLANTIC
Combi boiler central heating with thermostat control	L	L	L	L	L
uPVC double glazing	L	L	L	L	L
Integrated fridge/freezer	L	L	L	L	L
Integrated microwave	L	L	L	L	L
uPVC window & door colour change	✓	O	O	O	O
Fully galvanised chassis ¹	O	O	O	O	O
Pre-galvanised chassis ²	O	O	O	O	O
Winter additional floor insulation	✓	✓	✓	✓	✓
Environmental green cladding & matching uPVC windows	O	O	O	O	O
Canexel cladding in various colours	O	O	O	O	O
Artefoam high performance cladding	✓	O	O	O	O
Front & rear tow bar facility	✓	✓	✓	✓	✓
Outlook front doors (side doors on Belmor CL)	✓	O	✓	O	O
Bluetooth music centre	✓	O	O	O	O
Integrated dishwasher	✓	O	O	O	O
Integrated washing machine ³	O	O	O	O	O
Lounge scatter cushions	✓	✓	✓	✓	✓
Armchair(s) ⁴	X	✓	X	✓	X
SoCozeeee Mattresses	✓	✓	✓	✓	O
Bedding sets	O	O	O	O	O
Space saving fold-under bed to any twin bedroom ⁵	O	O	O	O	O
TV point & socket in bedroom 1	✓	✓	✓	✓	✓
TV point & socket in bedroom 2	✓	✓	✓	✓	O
TV point & socket in bedroom 3	O	O	O	O	O
USB points	✓	✓	✓	✓	✓

KEY

✓ = Included as standard
L = Available as part of the lifestyle pack
O = Optional extra
X = Not available

NOTES

1 - Upgrade from the conventional painted chassis (see note 2 below)
2 - Recommended in estuary/coastal areas with high salinity
3 - Being available for the range does not guarantee availability on models where layout does not allow
4 - Rimini has 2 armchairs as standard. Echo has 1 armchair as standard (except Echo 28/2 as layout does not allow)
5 - Not in conjunction with the SoCozeeee Mattress

PEACE OF MIND

Our team of experienced, knowledgeable leisure industry professionals pride themselves on exceeding manufacturing standards to provide you with a leisure home that will keep you safe and warm for many years to come.

We offer a two year warranty to all purchasers in the UK (subject to certain terms and conditions).



The full warranty is available on our website, or you can ask for a printed copy by sending a stamped, addressed envelope to the address on the back page.

For purchasers outside of the UK, please refer to your supplier for warranty details.

The warranty available is additional to and does not affect your statutory rights under consumer legislation.

FLOORPLAN SYMBOLS

Key to the symbols used on the floorplans throughout this brochure.

-  Electric Fire
-  Gas Boiler
-  Extractor
-  Optional Fridge/Freezer
-  Optional Microwave
-  Dishwasher
-  Shower
-  Bath
-  Wardrobe

ncc manufacturer member

www.thencc.org.uk





TWO YEAR WARRANTY



CONSTRUCTING QUALITY LEISURE HOMES

All of our leisure homes are built to exceed the minimum quality industry standard EN1647:2012, with energy efficient, hard wearing design that saves you money and reduces your impact on the environment whilst keeping you warm and safe for many years to come with the reassurance of a robust, quality design.

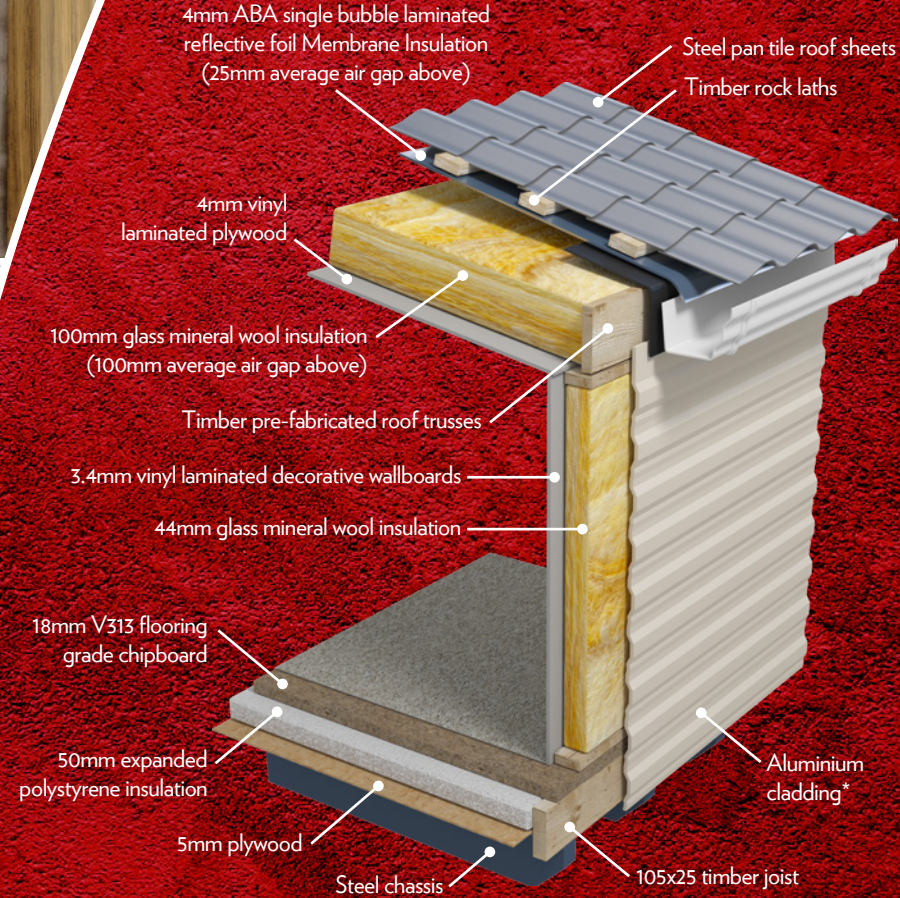

*Can be swapped for Artefoam or Canexel cladding with additional breather membrane and additional timber mounting battens (except Artefoam light colours)

MEASURMENTS

BECAUSE THE DETAILS MATTER

MODEL	METRIC (METRES)							IMPERIAL (FEET & INCHES)						
	L1	L2	L3	L4	W1	W2	H1/2	L1	L2	L3	L4	W1	W2	H1/2
Westpark 39 - 2	13.25	12.60	N/A	12.11	4.18	3.88	3.64	43'6"	41'4"	N/A	39'9"	13'9"	12'9"	11'11"
Westpark 41 - 3	13.96	13.31	N/A	12.82	4.18	3.88	3.64	45'10"	43'8"	N/A	42'1"	13'9"	12'9"	11'11"
Rimini 36 - 2	12.43	11.69	N/A	11.24	4.05	3.68	3.59	40'9"	38'4"	N/A	36'11"	13'3"	12'1"	11'9"
Rimini 38 - 2	13.06	12.32	N/A	11.87	4.05	3.68	3.59	42'10"	40'5"	N/A	38'11"	13'3"	12'1"	11'9"
Rimini 41 - 3	13.96	13.22	N/A	12.77	4.05	3.68	3.59	45'10"	43'4"	N/A	41'11"	13'3"	12'1"	11'9"
Belmor CL 39 - 2	13.25	12.51	N/A	12.06	4.05	3.68	3.59	43'6"	41'1"	N/A	39'7"	13'3"	12'1"	11'9"
Belmor CL 39 - 3	13.25	12.51	N/A	12.06	4.05	3.68	3.59	43'6"	41'1"	N/A	39'7"	13'3"	12'1"	11'9"
Echo 28 - 2	10.02	9.28	N/A	8.83	4.05	3.68	3.59	32'10"	30'5"	N/A	29'0"	13'3"	12'1"	11'9"
Echo 33 - 2	11.52	10.78	N/A	10.33	4.05	3.68	3.59	37'10"	35'4"	N/A	33'11"	13'3"	12'1"	11'9"
Echo 36 - 2	12.43	11.69	N/A	11.24	4.05	3.68	3.59	40'9"	38'4"	N/A	36'11"	13'3"	12'1"	11'9"
Echo 36 - 3	12.43	11.69	N/A	11.24	4.05	3.68	3.59	40'9"	38'4"	N/A	36'11"	13'3"	12'1"	11'9"
Echo 38 - 2	13.06	12.32	N/A	11.87	4.05	3.68	3.59	42'10"	40'5"	N/A	38'11"	13'3"	12'1"	11'9"
Echo 39 - 3	13.25	12.51	N/A	12.06	4.05	3.68	3.59	43'6"	41'1"	N/A	39'7"	13'3"	12'1"	11'9"
Atlantic 28 - 2	10.02	9.28	N/A	8.83	4.05	3.68	3.59	32'10"	30'5"	N/A	29'0"	13'3"	12'1"	11'9"
Atlantic 32 - 2	11.22	10.48	N/A	10.03	4.05	3.68	3.59	36'10"	34'4"	N/A	32'11"	13'3"	12'1"	11'9"
Atlantic 36 - 2	12.43	11.69	N/A	11.24	4.05	3.68	3.59	40'9"	38'4"	N/A	36'11"	13'3"	12'1"	11'9"
Atlantic 38 - 3	13.06	12.32	N/A	11.87	4.05	3.68	3.59	42'10"	40'5"	N/A	38'11"	13'3"	12'1"	11'9"

Before purchasing your Victory leisure home, we are sure you will want to know the exact measurements. The models are listed here in the order they appear in the brochure.

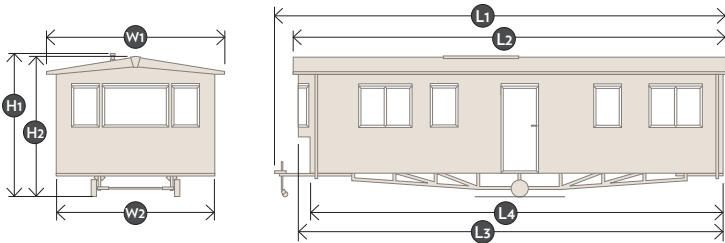

All dimensions are shown in metres (m) and imperial (feet / inches). All measurements are approximate and rounded to the nearest mm or inch. They could vary slightly due to the nature of the materials used, although the variance should not be significant. Please note that the floorplans throughout the brochure are indicative of the general layout only. They are not to scale and do not represent fully the shape and style of furniture and fittings or the detail of content.

IMPORTANT INFORMATION

THINGS TO KNOW WHEN BUYING A LEISURE HOME

In order for any Victory leisure home to be used, it needs to be correctly sited, have steps or other means of entry and be connected to services (an appropriate propane gas supply, mains electricity to suit the required wattage off-take, mains water at a pressure to suit the appliances and a waste water/sewage outlet).

Most models can be powered by mains electricity only, although some layout changes will be necessary. Victory recommends that you do not use the product for residential occupancy. All Victory leisure homes are built to comply with many European and British Standards and all relevant codes of practice required by the National Caravan Council Certification Scheme and those endorsed by The British Holiday and Home Parks Association. These include the recommendation that caravan holiday homes should only be used for temporary holiday occupancy.

The sizes given are reasonably accurate shell measurements, but if your chosen pitch has size limitations or obstructions, you should consult with your park operator or dealer to establish specific sizes.

Illustrations, photographs, descriptions, information and statements contained in any Victory Leisure Homes Ltd literature are intended only as a general guide. They are relevant to the product at the time of writing and production. Victory Leisure Homes Ltd reserves the right to change any materials, fittings, sizes etc. at any time and without prior notice as supply, product development or legislation conditions demand. The matching and lining-up of patterns on wall-boards and fabrics is not always possible because of the caravan design and methods of construction.

Some of the items photographed (some refrigerators, fridge/freezers, microwaves, televisions, media players, some soft furnishings for beds and general props) are for illustration purposes only. Please refer to your park or dealer if you need clarification.

All Victory leisure homes are built to meet the requirements of EN1647 for snow loading categories A & B provided that the caravan is sited as recommended in the relevant code of practice for siting.

Please note: the description given for some features is not always applicable to every model within any range as there may be legal, technical or layout requirements that may create the need to alter or leave out the stated feature. Also, any item pictured may be different in size or style in other models within the range. Please be aware that supplied appliances and fittings may vary from those described as manufacturers may change, update or make obsolete and introduce new models. Such changes are beyond our control and we draw your attention to the fact that we reserve the right to change as these supply implications take effect. If any feature is critical to your purchasing decision, it would be wise to check beforehand exactly what is supplied with your chosen model.

Image: Parkview Centre Lounge at Wenningdale Escapes in the Yorkshire Dales



TAKE A
VIRTUAL TOUR
AND VIEW ALL OF
OUR BROCHURES
ONLINE

LODGE
COLLECTION

Why not consider the ultimate home from home with an elegant lodge of the highest quality? Built to BS3632:2015 Residential Specification, with sizes and styles for all tastes, and prices to suit a range of budgets.

CÉZANNE

Our flagship lodge comes with all the latest design trends and modern technology to create the ultimate luxury holiday home.

MONACO DUO

Tasteful, traditional and stylish, with modern conveniences all built in, our popular Monaco Duo now has a brand new centre lounge model.

PARKVIEW

Our most versatile range, with a great choice of layout options to suit almost any family and a range of budgets.

BEECHWOOD

Spacious and practical, the Beechwood is a great value entry-level lodge with plenty of layouts and optional features.



Victory Leisure Homes Ltd.
Broad Lane | Gilberdyke | East Yorkshire | HU15 2TS

01430 471 200
www.victoryleisurehomes.co.uk
sales@victoryleisurehomes.co.uk



Your local park/dealer details: