

# THE WESTWOOD LODGE

There's nothing else quite like it

Style, substance, space, The Westwood's got it all. From striking wood feature walls to statement radiators, its design details break the mould. And with must-haves like a wine cooler and built-in wireless charging, it doesn't skip a beat on the features front either.





## Highlights

- The ultimate in holiday homes
- Sumptuous master bedroom with dressing area and en suite shower
- Spacious twin room with 3' beds
- Luxury kitchen
- Built to BS3632 residential specification
- Contemporary styling throughout



To take an interactive virtual tour  
visit [www.abiuk.co.uk](http://www.abiuk.co.uk)



**Please note:** Some items featured in this photography are scene-setting props or optional extras, not included in your purchase. Please speak to your park or dealership or refer to the 'all this included' section for this holiday home.



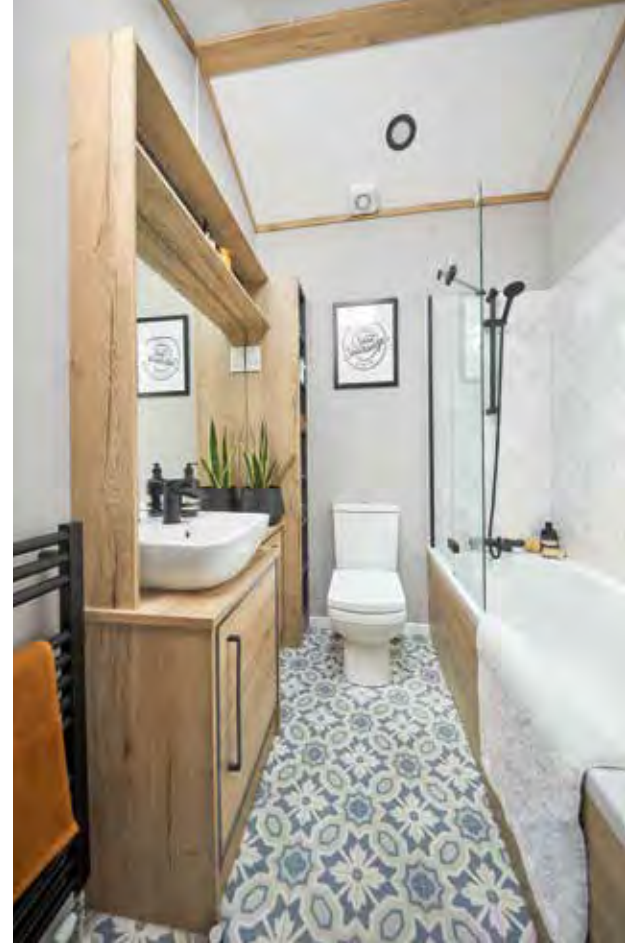

# The Westwood Lodge

Lavished with every single luxury you could wish for, this quite exceptional holiday home is carefully crafted to deliver uniquely relaxing breaks.

For external CanExel™ Cladding option please visit [www.abiuk.co.uk](http://www.abiuk.co.uk)



FACTORY  
Approved



For further information and to take an interactive virtual tour of The Westwood Lodge visit [www.abiuk.co.uk](http://www.abiuk.co.uk)

## All this included

- ✓ Chateaux grey hard PVCu cladding
- ✓ Fully galvanised heavy-duty chassis
- ✓ Graphite Grey 'Low E' PVCu Thermaglass double glazing
- ✓ Fully condensing boiler gas central heating
- ✓ Satellite co-ax
- ✓ Carpet underlay throughout
- ✓ Free-standing domestic style furniture
- ✓ Externally vented powered cooker hood
- ✓ Soft-close hinges on doors and drawers throughout
- ✓ Slate effect 25mm kitchen worktops
- ✓ Composite kitchen sink
- ✓ Free-standing dining table and 6 chairs
- ✓ Integrated fridge freezer
- ✓ 5 burner gas hob including wok burner
- ✓ Integrated dishwasher
- ✓ Integrated microwave
- ✓ Rooflight window in kitchen
- ✓ Corner pull out shelving unit in the kitchen
- ✓ Wine cooler in kitchen
- ✓ Wireless phone charging station
- ✓ Front patio doors
- ✓ Entrance hall and cloakroom
- ✓ Electric fire
- ✓ USB socket in lounge
- ✓ Scatter cushions in lounge
- ✓ Pictures in hallway and bathroom
- ✓ Feature wood panelling walls in lounge and both bedrooms

- ✓ Stylish wall lights in lounge
- ✓ Feature fireplace with wooden beam and classic mirror
- ✓ Contemporary radiator in lounge
- ✓ King size bed in master bedroom
- ✓ Lift-up bed in master bedroom
- ✓ TV point in all bedrooms
- ✓ USB sockets in all bedrooms (includes USB sockets on both sides of the main bed)
- ✓ Plain duvet covers and pillowcases
- ✓ Bed throws and scatter cushions on all beds
- ✓ 3' single beds
- ✓ Separate en suite shower and toilet
- ✓ Bathroom extractor fans
- ✓ Shaver socket
- ✓ Coat hooks in all bathrooms and master bedroom
- ✓ Luxury soft-close toilets
- ✓ Bathroom with domestic style bath

## Add any of these

- CanExel™ exterior cladding (available in D5 Ridgewood or Ced-R Vue styles)
- Voiles throughout
- Deluxe Bluetooth sound system
- Integrated washing machine
- TV facility in lounge above fireplace in lieu of mirror
- 'Exclusive' pocket sprung mattresses
- Space saver bed for twin room

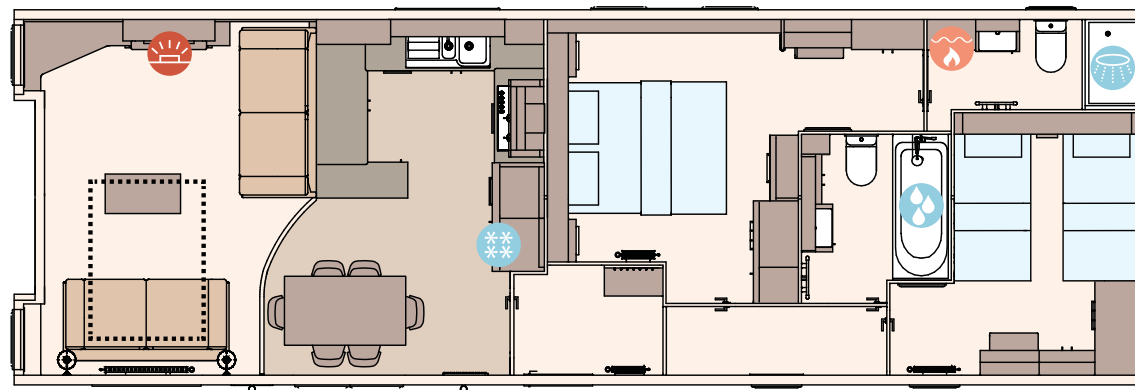

The Westwood Lodge 44ft x 14ft x 2 bedroom

KEY: Fire Water heater Shower Bath Fridge/Freezer Front pull out bed

Residential  
specification  
BS3632  
See Page 83