



Victory
Leisure Homes

2017
**Leisure Home
Collection**

Groewood Lux * Groewood * Sandhurst * Sandhurst CL * Torino Super * Coaster



We create luxury leisure homes for you to enjoy all year round

Our 2017 leisure home range has been designed with you in mind. This year we have 19 models for you to choose from across 6 ranges - all of which are packed with innovative design features with their own unique and beautiful style.

With Victory Leisure Homes you get a fantastic selection and value for money from a range that is hard to beat. All of our leisure home models come complete with uPVC double glazing and central heating, and for 2017 all models (except the Coaster) now have a fully galvanised chassis with encapsulated insulation as standard.

Over the past year our design and development team have been working tirelessly in an effort to launch a range of leisure homes that we can be proud of, we hope that you will be equally proud to own one.

For more information please visit our website at www.victoryleisurehomes.co.uk

**With Victory Leisure Homes we know you'll
find what you're looking for.**

Peter T. Nevitt
Managing Director



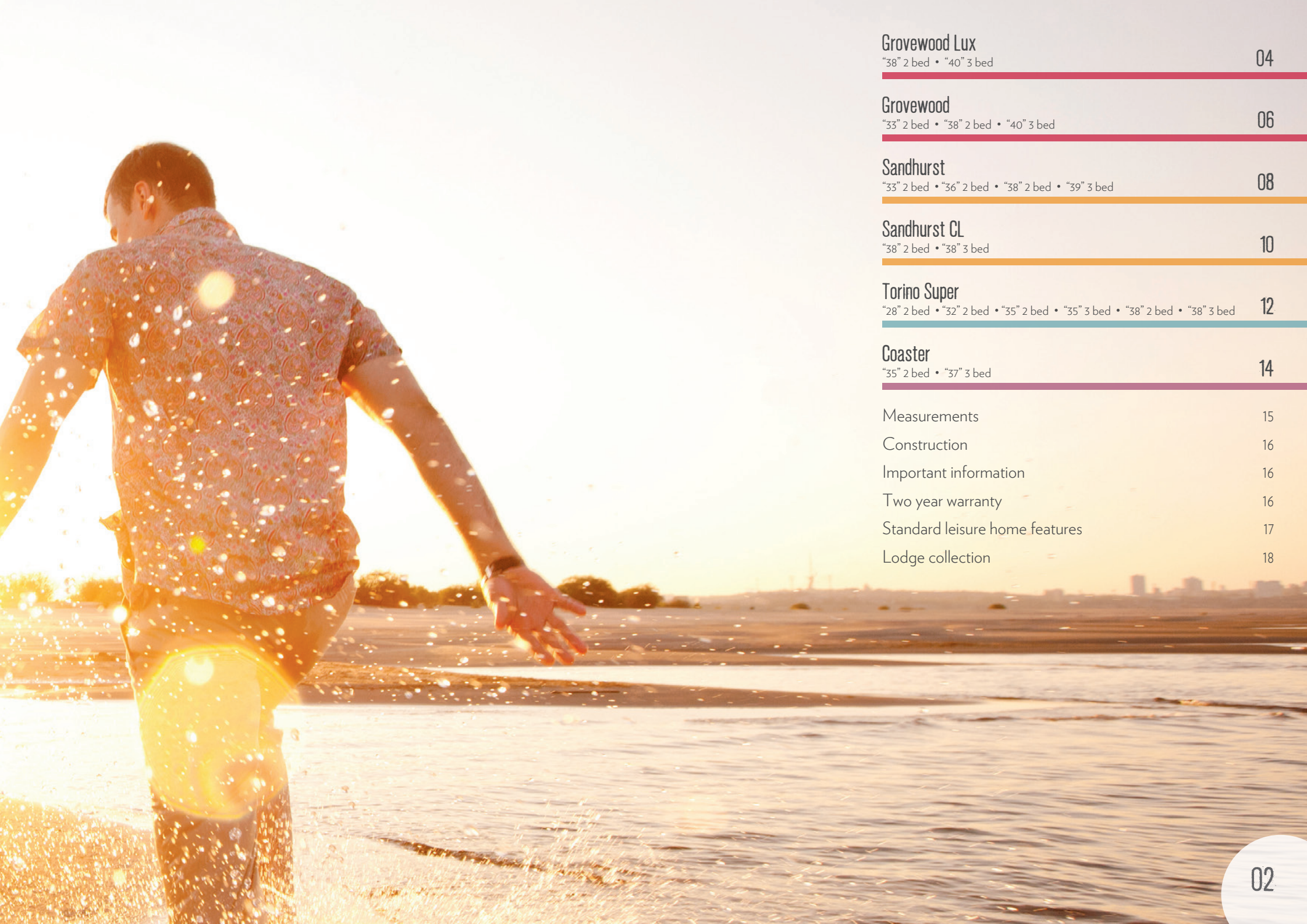

Groewood Lux

"38" 2 bed • "40" 3 bed

04

Groewood

"33" 2 bed • "38" 2 bed • "40" 3 bed

06

Sandhurst

"33" 2 bed • "36" 2 bed • "38" 2 bed • "39" 3 bed

08

Sandhurst CL

"38" 2 bed • "38" 3 bed

10

Torino Super

"28" 2 bed • "32" 2 bed • "35" 2 bed • "35" 3 bed • "38" 2 bed • "38" 3 bed

12

Coaster

"35" 2 bed • "37" 3 bed

14

Measurements

15

Construction

16

Important information

16

Two year warranty

16

Standard leisure home features

17

Lodge collection

18





Grovewood Lux 38 • 2 Bedrooms



Grovewood Lux 40 • 3 Bedrooms



Main Features

- uPVC double glazing with coloured frames
- Combi boiler central heating
- Integrated fridge/freezer
- Integrated microwave
- Integrated dishwasher
- Insulated 50mm external walls
- Insulation to all exposed water pipes
- Fusion fully galvanised chassis with encapsulated insulation
- Externally vented cooker hood with light
- Drop down glass lid to cooker
- Coffee table
- Close-coupled ceramic toilets with dual flush
- Vaulted ceilings throughout
- Steel pantile peaked insulated roof
- High performance cladding
- Voile curtains to most windows
- Sliding wardrobe doors
- Domestic gutters with rainwater fall pipes
- Energy efficient glass
- Tow bar with front and rear use
- Colour co-ordinated lounge scatter cushions
- Bedding pack
- Bluetooth music centre
- TV point to master bedroom
- LED lamps to most light fittings
- USB charging ports
- Sliding patio front door

Popular Optional Extras

- Environmental exterior with colour co-ordinated uPVC windows & doors
- Choice of external claddings in various colours



Deck supplied by D&J Leisure Ltd, Hull

Grovewood Lux

The ultimate in luxury leisure home living

New for 2017, the Grovewood Lux builds on the appeal of the popular Grovewood. It is larger in size and offers a wealth of extra features including upgraded appliances, music centre, high performance cladding and beautiful sliding patio doors. With its lavish dark wood interior and unique column feature in the open plan living area, the Grovewood Lux offers a luxury lifestyle in a truly premium quality leisure home.

Key Features

- Double glazing and central heating
- Galvanised chassis with encapsulated insulation
- Dark wood décor with matt chrome sockets
- High performance cladding
- USB charging points
- 12' 6" wide







Grovewood 33 • 2 Bedrooms

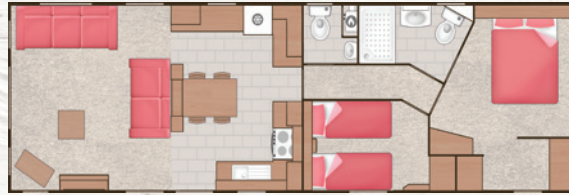

Grovewood 38 • 2 Bedrooms



Grovewood 40 • 3 Bedrooms

Main Features

- uPVC double glazing with coloured frames
- Combi boiler central heating
- Integrated microwave
- Insulated 50mm external walls
- Insulation to all exposed water pipes
- Fusion fully galvanised chassis with encapsulated insulation
- Externally vented cooker hood with light
- Coffee table
- Close-coupled ceramic toilets with dual flush
- Vaulted ceilings throughout
- Steel pantile peaked insulated roof
- Voile curtains to most windows
- Domestic gutters with rainwater fall pipes
- Energy efficient glass
- Tow bar with front and rear use
- Colour co-ordinated lounge scatter cushions
- TV point to master bedroom
- LED lamps to most light fittings
- USB charging ports
- Integrated fridge/freezer
- Single front door

Popular Optional Extras

- Environmental exterior with colour co-ordinated uPVC windows & doors
- Choice of external claddings in various colours



Grovewood

Stylish and innovative leisure home living

The Grovewood is an exclusive leisure home that benefits from innovative and luxurious features throughout. It is set apart from other leisure homes by a number of unique design features like the central column focal point that takes centre stage in-between the kitchen and living area, or the modern sofas that create a true home-from-home feel. The Grovewood really does set the standard for contemporary leisure home life.

Key Features

- Double glazing and central heating
- Galvanised chassis with encapsulated insulation
- Dark wood décor with matt chrome sockets
- Integrated fridge/freezer and microwave
- USB charging points
- High standard specification







Sandhurst 33 • 2 Bedrooms



Sandhurst 36 • 2 Bedrooms



Sandhurst 38 • 2 Bedrooms



Sandhurst 39 • 3 Bedrooms



Main Features

- uPVC double glazing
- Combi boiler central heating
- Insulated 50mm external walls
- Insulation to all exposed water pipes
- Fusion fully galvanised chassis with encapsulated insulation
- Externally vented cooker hood with light
- Coffee table
- Close-coupled ceramic toilets with dual flush
- Vaulted ceilings throughout
- Steel pantile peaked insulated roof
- Voile curtains to most windows
- Domestic gutters with rainwater fall pipes
- Energy efficient glass
- Tow bar with front & rear use
- Colour co-ordinated lounge scatter cushions
- TV point to master bedroom
- External light
- Integrated fridge/freezer
- Integrated Microwave
- USB charging points to lounge & bedrooms
- LED lamps to most light fittings

Popular Optional Extras

- Environmental exterior with colour co-ordinated uPVC windows & doors
- Choice of external claddings in various colours
- Front door option



Leading the way with stylish innovations

We're sure you will agree that the Sandhurst offers the perfect combination of innovation and style, as you enjoy those special summer evenings with the family in the spacious open plan lounge, kitchen and dining area. Features include design elements with long lasting appeal like USB charging points, en-suite bathroom and integrated kitchen appliances, and the modern pastel yellow décor throughout is perfectly on trend for 2017.

Key Features

- Double glazing and central heating
- Galvanised chassis with encapsulated insulation
- Energy efficient glass
- Integrated fridge/freezer & microwave
- En-suite bathroom
- USB charging points







Sandhurst CL 38 • 2 Bedrooms



Sandhurst CL 38 • 3 Bedrooms



Main Features

- uPVC double glazing
- Combi boiler central heating
- Insulated 50mm external walls
- Insulation to all exposed water pipes
- Fusion fully galvanised chassis with encapsulated insulation
- Externally vented cooker hood with light
- Coffee table
- Close-coupled ceramic toilet/s with dual flush
- Vaulted ceilings throughout
- Steel pantile peaked insulated roof
- Voile curtains to most windows
- Domestic gutters with rainwater fall pipes
- Energy efficient glass
- Tow bar with front and rear use
- Colour co-ordinated lounge scatter cushions
- TV point to master bedroom
- External light
- Integrated fridge/freezer
- Integrated Microwave
- USB charging points to lounge & bedrooms
- LED lamps to most light fittings

Popular Optional Extras

- Environmental exterior with colour co-ordinated uPVC windows & doors
- Choice of external claddings in various colours



Sandhurst CL

Spacious, stylish, quality
open plan living

Brand new for 2017, the Sandhurst CL is designed to provide all the space and features a modern family requires. The central open plan living area provides a perfect family gathering place. There are shower rooms at each side and the 2 bedroom option has an impressively spacious layout with two full size 3ft single beds. Central lounge layouts are set to be the new trend in leisure home design and we know this is going to be a popular addition to the range.

Key Features

- Double glazing and central heating
- Galvanised chassis with encapsulated insulation
- Energy efficient glass
- Integrated fridge/freezer & microwave
- Two shower rooms
- USB charging points







Torino Super 28
2 Bedrooms



Torino Super 32
2 Bedrooms



Torino Super 35
2 Bedrooms



Torino Super 35
3 Bedrooms



Torino Super 38
2 Bedrooms



Torino Super 38
3 Bedrooms

Main Features

- uPVC double glazing
- Combi boiler central heating
- Insulated 50mm external walls
- Insulation to all exposed water pipes
- Fusion fully galvanised chassis with encapsulated insulation
- Externally vented cooker hood with light
- Coffee table
- Close-coupled ceramic toilet/s with dual flush
- Vaulted ceilings throughout
- Steel pantile peaked insulated roof
- Voile curtains to most windows
- Domestic gutters with rainwater fall pipes
- Energy efficient glass
- Tow bar with front & rear use
- Colour co-ordinated lounge scatter cushions
- TV point to master bedroom
- External light
- Free standing fridge/freezer
- USB charging points to lounge & bedrooms
- LED lamps to most light fittings

Popular Optional Extras

- Environmental exterior with colour co-ordinated uPVC windows & doors
- Choice of external claddings in various colours
- Front door option
- Integrated microwave
- Integrated fridge/freezer

Torino Super

Bringing the outdoors in

Enjoy panoramic views thanks to the unique three panel windows that bring the outdoors into your living area with the Torino Super. The spacious open-plan living area and innovative new layouts including ample storage make the new Torino Super both practical and contemporary. With natural tones throughout and a huge range of layouts and options available, the Torino is perfect for couples and families alike to create their ideal getaway.

Key Features

- Double glazing and central heating
- Galvanised chassis with encapsulated insulation
- Energy efficient glass
- Panoramic Windows
- Free-standing fridge/freezer
- USB charging points







Coaster 35 • 2 Bedrooms



Coaster 37 • 3 Bedrooms



Main Features

- uPVC double glazing with coloured frames
- Combi boiler central heating
- Insulated 50mm external walls
- Insulated floor with insulation to all exposed water pipes
- Externally vented cooker hood with light
- Integrated Fridge/Freezer
- Coffee table
- Close-coupled ceramic toilets with dual flush
- Vaulted ceilings throughout
- Steel pantile peaked insulated roof
- Voile curtains to most windows
- Domestic gutters with rainwater fall pipes
- Galvanised corner steadies & tow bar with front and rear use
- TV point in master bedroom
- External light

Popular Optional Extras

- Fusion fully galvanised chassis
- Integrated microwave
- Environmental green external cladding



Bringing style, quality, and great value together

The Coaster proves that value for money shouldn't have to mean compromising on style, quality or comfort. The generous lounge features comfy, wrap-around seating and welcoming décor with co-ordinated fabrics. The fully equipped kitchen has a fitted cooker and hood, and integrated fridge/freezer. Add to that ample storage space not often found in a modern holiday home, and the Coaster really is hard to beat.

Key Features

- Double glazing
- uPVC coloured windows
- Central heating
- Integrated fridge/freezer
- Ample storage space
- Externally vented cooker hood with light



Measurements

Before purchasing your Victory leisure home, we are sure you will want to know the exact measurements. The models are listed here in the order they appear in the brochure along with their page number to make them easy to find.

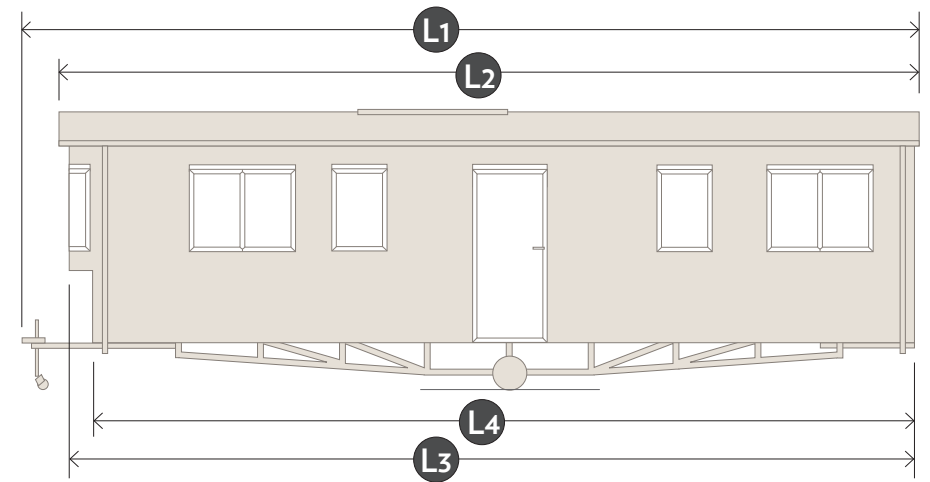
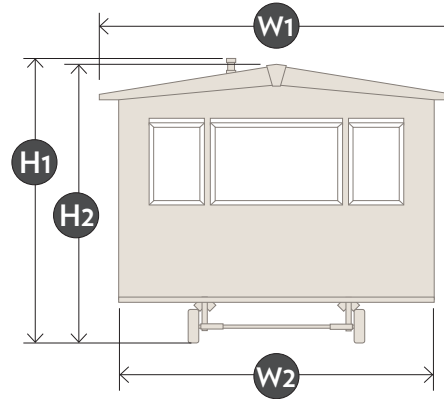

Imperial (feet & inches)

Metric (meters)

		L1	L2	L3	L4	W1	W2	H1/H2	L1	L2	L3	L4	W1	W2	H1/H2
Groveswood Lux 38 - 2 bed	Pg 4	43'1"	41'	39'9"	39'	13'9"	12'8"	11'5"	13.13m	12.49m	12.16m	11.89m	4.24m	3.87m	3.49m
Groveswood Lux 40 - 3 bed	Pg 4	45'	42'9"	41'9"	40'11"	13'9"	12'8"	11'5"	13.73m	13.09m	12.76m	12.22m	4.24m	3.87m	3.49m
Groveswood 33 - 2 bed	Pg 6	37'6"	34'7"	N/A	33'11"	13'3"	12'1"	11'4"	11.45m	10.59m	N/A	10.09m	4.05m	3.68m	3.47m
Groveswood 38 - 2 bed	Pg 6	42'6"	39'8"	N/A	38'11"	13'3"	12'1"	11'4"	12.99m	12.13m	N/A	11.61m	4.05m	3.68m	3.47m
Groveswood 40 - 3 bed	Pg 6	44'6"	41'8"	N/A	40'11"	13'3"	12'1"	11'4"	13.59m	12.73m	N/A	12.22m	4.05m	3.68m	3.47m
Sandhurst 33 - 2 bed	Pg 8	37'6"	35'3"	34'6"	33'11"	13'3"	12'1"	11'4"	11.45m	10.76m	10.55m	10.09m	4.05m	3.68m	3.47m
Sandhurst 36 - 2 bed	Pg 8	40'2"	37'9"	37'2"	36'6"	13'3"	12'1"	11'4"	12.25m	11.56m	11.35m	11.15m	4.05m	3.68m	3.47m
Sandhurst 38 - 2 bed	Pg 8	42'6"	40'3"	39'7"	38'11"	13'3"	12'1"	11'4"	12.99m	12.30m	12.09m	11.61m	4.05m	3.68m	3.47m
Sandhurst 39 - 3 bed	Pg 8	43'6"	41'3"	40'6"	39'11"	13'3"	12'1"	11'4"	13.29m	12.60m	12.39m	11.92m	4.05m	3.68m	3.47m
Sandhurst CL 38 - 2 bed	Pg 10	42'2"	39'1"	N/A	38'11"	13'3"	12'1"	11'4"	12.94m	11.93m	N/A	11.61m	4.05m	3.68m	3.47m
Sandhurst CL 38 - 3 bed	Pg 10	42'2"	39'1"	N/A	38'11"	13'3"	12'1"	11'4"	12.94m	11.93m	N/A	11.61m	4.05m	3.68m	3.47m
Torino Super 28 - 2 bed	Pg 12	32'8"	29'8"	N/A	29'	13'3"	12'1"	11'4"	10.0m	9.09m	N/A	8.84m	4.05m	3.68m	3.47m
Torino Super 32 - 2 bed	Pg 12	36'6"	33'8"	N/A	32'11"	13'3"	12'1"	11'4"	11.15m	10.29m	N/A	9.79m	4.05m	3.68m	3.47m
Torino Super 35 - 2 bed	Pg 12	39'6"	36'7"	N/A	35'11"	13'3"	12'1"	11'4"	12.06m	11.20m	N/A	10.7m	4.05m	3.68m	3.47m
Torino Super 35 - 3 bed	Pg 12	39'6"	36'7"	N/A	35'11"	13'3"	12'1"	11'4"	12.06m	11.20m	N/A	10.7m	4.05m	3.68m	3.47m
Torino Super 38 - 2 bed	Pg 12	42'3"	39'5"	N/A	38'7"	13'3"	12'1"	11'4"	12.89m	12.03m	N/A	11.79m	4.05m	3.68m	3.47m
Torino Super 38 - 3 bed	Pg 12	42'3"	39'5"	N/A	38'7"	13'3"	12'1"	11'4"	12.89m	12.03m	N/A	11.79m	4.05m	3.68m	3.47m
Coaster 35 - 2 bed	Pg 14	39'6"	37'3"	36'6"	35'11"	13'3"	12'1"	11'4"	12.06m	11.37m	11.16m	10.7m	4.05m	3.68m	3.47m
Coaster 37 - 3 bed	Pg 14	41'6"	39'4"	38'7"	37'11"	13'3"	12'1"	11'4"	12.6m	12.0m	11.79m	11.31m	4.05m	3.68m	3.47m

All dimensions are shown in metres (m) and imperial (feet / inches). All measurements are approximate and rounded to the next mm or inch. They could vary slightly due to the nature of the materials used, although the variance should not be significant. Please note that the floorplans throughout the brochure are indicative of the general layout only. They are not totally to scale and do not represent fully the shape and style of furniture and fittings or the detail of content.



Construction

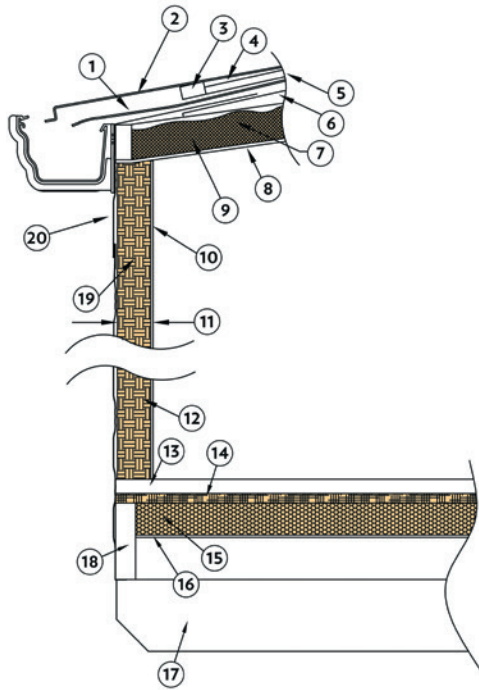

1. 4mm ABA Single Bubble Laminated Reflective Foil Membrane Insulation
2. Steel Pan Tile Roof Sheets
3. Timber Rock Laths
4. 25mm Average Air Gap
5. Roof Section
6. 30mm Average Air Gap
7. 50mm Glass Mineral Wool Insulation
8. 4mm Vinyl Laminated Hardboard
9. Timber Pre-Fabricated Roof Trusses
10. 3.4mm Vinyl Laminated Decorative Wallboards
11. 47mm Wall Thickness (Excluding Cladding)
12. Side Wall Section
13. 18mm V313 Chipboard Floor
14. 10mm Natural Fibre Insulation Board
15. 40mm Expanded Polystyrene Insulation
16. 5mm Plywood
17. Steel Chassis
18. 96mmx25mm Timber Joist
19. 44mm Glass Mineral Wool Insulation
20. Aluminium, Plastic or Timber Log Cladding

Important Information

In order for any Victory leisure home to be used, it needs to be correctly sited, have steps or other means of entry and be connected to services (an appropriate propane gas supply, mains electricity to suit the required wattage off-take, mains water at a pressure to suit the appliances and a waste water/sewage outlet).

Most models can be powered by mains electricity only, although some layout changes will be necessary. Victory recommends that you do not use the product for residential occupancy. All Victory leisure homes are built to comply with many European & British Standards and all relevant Codes of Practice required by the National Caravan Council Certification Scheme and those endorsed by The British Holiday and Home Parks Association. These include the recommendation that caravan holiday homes should only be used for temporary holiday occupancy.

The sizes given are reasonably accurate shell measurements, but if your chosen pitch has size limitations or obstructions, you should consult with your Park Operator or Dealer to establish specific sizes.

Illustrations, photographs, descriptions, information and statements contained in any Victory Leisure Homes Limited literature are intended only as a general guide. They are relevant to the product at the time of writing and production. Victory Leisure Homes Ltd. reserves the right to change any materials, fittings, sizes etc. at any time and without prior notice as supply, product development

or legislation conditions demand. The matching and lining-up of patterns on wall-boards and fabrics is not always possible because of the caravan design and methods of construction.

Some of the items photographed (some refrigerators, fridge/freezers, microwaves, televisions, media players, some soft furnishings for beds and general props) are for illustration purposes only. Please refer to your Park or Dealer if you need clarification.

All Victory leisure homes are built to meet the requirements of EN1647 for snow loading categories A & B provided that the caravan is sited as recommended in the relevant Code of Practice for siting.

Please note: The description given for some features is not always applicable to every model within any range as there may be legal, technical or layout requirements that may create the need to alter or leave out the stated feature. Also, any item pictured may be different in size or style in other models within the range. Please be aware that supplied appliances and fittings may vary from those described as manufacturers may change, update or make obsolete and introduce new models. Such changes are beyond our control and we draw your attention to the fact that we reserve the right to change as these supply implications take effect. If any feature is critical to your purchasing decision, it would be wise to check beforehand exactly what is supplied with your chosen model.

Two Year Warranty

The combination of solid construction and evolutionary design integrated with comfort and function, demonstrates the depth of knowledge and long experience that the management and staff of Victory Leisure Homes have gained over many years working within the leisure home industry.

This underpinning gives us the confidence to offer a two year warranty to all purchasers within the UK subject to certain terms and conditions. The warranty can be viewed and downloaded on the website www.victoryleisurehomes.co.uk or by sending a stamped addressed envelope to the address on the back page. For purchasers outside of the UK, please refer to your supplier for warranty details. The warranty available is additional to and does not affect your statutory rights under consumer legislation.

Standard Features in our Leisure Homes

In 2017 Victory Leisure Homes have more features in their standard specification than ever before, making sure that you get the maximum comfort and value from your leisure home.

Central Heating, Double Glazing & Insulation

Sit back, relax and know that you will always be warm in your Victory leisure home because all models come with central heating, along with double glazing and insulation to make sure you stay warm whilst also conserving energy usage. All windows (except on the Coaster) are also made from energy efficient glass.

Galvanised Chassis (most models)

A galvanised chassis ensures the longer term structural and cosmetic integrity of your leisure home, and is a necessity for leisure homes by the sea to prevent corrosion. With that in mind, all of our models (except the Coaster) now come with this feature as standard with encapsulated insulation - exclusive to Victory Leisure Homes.

USB Ports & Shaver Sockets (most models)

We believe that your home from home should have as many modern conveniences as possible, so as well as traditional shaver sockets, we now fit all our leisure homes (except the Coaster) with sockets that have USB charging points in the living room and bedrooms so you can charge all your devices easily and without using up valuable plug sockets.



USB charging point in the Torino Super



A fully galvanised chassis with encapsulated insulation



USB charging point in the Grovewood Lux



Lodge Collection

Welcome to a more luxurious way to live

At Victory our philosophy is based on a real desire to provide elegant, best-quality lodge homes at affordable prices, backed up with a high standard of service.

Our 2017 collection consists of 16 lodges with a choice of 13ft, 16ft or 20ft widths - presenting new versatile features and colour combinations. Each model has a different design inspiration introducing new ideas, not only for style, but for practical and comfortable living. Our approach is discreet yet elegant with natural tones and modern colours designed to work together. Add to this an extensive list of appliances and features and you will see why all of our lodges are truly luxurious.

- | | |
|-------------------------|-------------------------|
| Parkview | Monaco |
| Parkview 40x16 2 bed | Monaco 41x13 2 bed |
| Parkview 40x16 3 bed | |
| Parkview 29x20 2 bed | Monaco Duo |
| Parkview 36x20 2 bed | Monaco Duo 40x20 2 bed |
| Parkview 40x20 2 bed | Monaco Duo 41x20 3 bed |
| Parkview 40x20 2 bed CL | |
| Parkview 41x20 3 bed | Provence |
| Parkview 46x20 4 bed | Provence 40x20 2 bed |
| | Provence 40x20 2 bed CL |
| Versailles | Provence 41x20 3 bed |
| Versailles 40x20 2 bed | |
| Versailles 41x20 3 bed | |



◀ Photos of the Victory Versailles Lodge



Victory
Leisure Homes

Victory Leisure Homes Ltd | Broad Lane | Gilberdyke | East Yorkshire | HU15 2TS
01430 471 200 | www.victoryleisurehomes.co.uk | sales@victoryleisurehomes.co.uk



Victory Leisure Homes



@VictoryLeisure



VictoryLeisureHomes



Victory Leisure Homes

