



HOLIDAY HOMES
OF DISTINCTION

2017 COLLECTION

www.carnabycaravans.com



WELCOME

Carnaby's mission for the last four decades has been to present a holiday home away from home.

This year sees the evolution of the Carnaby Comfort standard, raising levels of rest and relaxation by exceeding insulation values thanks to Ultra Warm and Ultra Warm Plus upgrades. This means that the Structural Thermal Rating of each model has increased* and is optimised to create the perfect environment for comfortable living.

Whilst retaining all of the features that set our industry leading Carnaby Comfort standard and made our 2016 collection so popular, this year we've really focused on the details of that standard.

We've added two new models to our range in the Stamford Lodge and the Hainsworth, which build on the stunning success of last year's collection. Whatever you are looking for, Carnaby has the perfect solution to fit your lifestyle and budget.

* Increase per model is compared to 2016 NCC Structural Thermal Ratings



CONTENTS

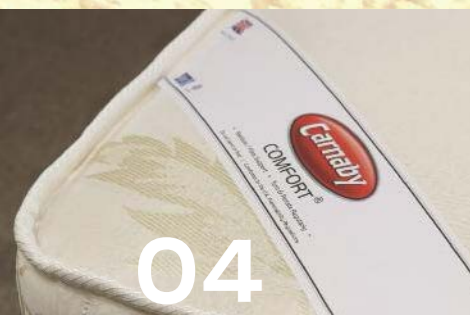

04

COMFORT



06

ENVOY



10

STAMFORD
LODGE



14

HELMSLEY
LODGE



18

HAINSWORTH



22

OAKDALE



28

ASHDALE

FLOOR PLANS	32
EXTERNAL SIZES	36
EXTERIOR FINISHES	37
SPECIFICATIONS & OPTIONS	38



ATTENTION TO EVERY DETAIL

It's the little things that make all the difference, so we've approached each tiny feature and shaped it with your satisfaction in mind.



COMFORT

"At Carnaby, we don't believe you should leave your domestic comfort at home. That's why we have provided domestic sized and quality seating in all our models. Also, why should you have a poor night's sleep when you are on holiday? Carnaby Comfort mattresses, designed and manufactured in the UK exclusively for us, are standard right across the range. Visit your local stockist to take the Carnaby Comfort test for yourself."

Nigel Smailes, CEO



SUPERIOR SEATING AS STANDARD

To enable absolute relaxation when you need it most, all of our models include full-size, domestic quality seating.

IN CHARGE OF COMFORT

Wherever you sit down or lay your head, you'll find an integrated USB charging station within easy reach, keeping you connected at all times.



DREAMING OF COMFORT

Our deluxe mattresses are specially designed to promote sound, cozy and rejuvenating sleep.



KEEPING YOUR GUESTS IN COMFORT

Fold out beds could never be described as comfortable and worse still they seriously compromise the comfort of your sofa in everyday use. That's why we are offering the option of an Aerobed, giving your guests a great night's sleep and retaining our high Carnaby Comfort standard for day-to-day living.

AMBIENT COMFORT

Comfort comes in many forms which is why we've invested in improving the insulation properties of our holiday homes.

Carnaby's research and development team have increased the insulation values of the walls, floors, ceilings and windows - further improving comfort levels within units fitted with our Ultra Warm and new Ultra Warm Plus options.

The NCC Structural Thermal Rating Scheme is designed to give purchasers of caravan holiday homes built to EN 1647 the opportunity to compare the relative thermal efficiency between all manufacturers and their models on a level playing field.

STRUCTURAL THERMAL RATING



COMFORT

	2016 ULTRA WARM	2017 ULTRA WARM	2017 ULTRA WARM PLUS
ENVOY			
40 x 13 - 2 Bedroom	7.9	8.5	9.1
STAMFORD LODGE			
39 x 13 - 2 Bedroom	N/A	8.4	9
HELMSLEY LODGE			
37 x 13 - 2 Bedroom	7.9	8.4	9
37 x 13 - 3 Bedroom	7.8	8.4	9
39 x 13 - 2 Bedroom	7.9	8.5	9
39 x 13 - 3 Bedroom	7.9	8.4	9
HAINSWORTH			
36 x 12 - 2 Bedroom	N/A	8.4	8.9
39 x 12 - 2 Bedroom	N/A	8.4	9
39 x 12 - 3 Bedroom	N/A	8.4	9
OAKDALE			
32 x 12 - 2 Bedroom	7.9	8.3	8.9
35 x 12 - 2 Bedroom	7.9	8.4	8.9
36 x 12 - 3 Bedroom	N/A	8.4	9
37 x 12 - 2 Bedroom	8	8.5	9
38 x 12 - 3 Bedroom	8	8.5	9
OAKDALE CL			
34 x 12 - 2 Bedroom	8.1	8.6	9
37 x 12 - 2 Bedroom	8.2	8.7	9.1
37 x 12 - 3 Bedroom	8.2	8.7	9.1
ASHDALE			
30 x 12 - 2 Bedroom	N/A	8.5	9
32 x 12 - 2 Bedroom	7.6	8.4	8.9
35 x 12 - 2 Bedroom	7.7	8.5	9
36 x 12 - 3 Bedroom	7.7	8.5	9



WALL
50mm Superglass

ROOF
120mm Superglass

FLOOR
Foiltec Double Foil

GLAZING
uPVC Double Glazed



WALL
50mm High Density Superglass

ROOF
100mm High Density Superglass

FLOOR
Foiltec Double Foil + 25mm Superglass

GLAZING
uPVC Double Glazed 'Low E' Glass Argon Filled



Envoy 40 x 13 - 2

ENVOY

Carnaby has changed and the Envoy has been designed to deliver that message. We have created an exclusive, ultra-premium holiday home like no other.

Every aspect of the Envoy has been designed from the ground up, from the open-plan layout and luxury loft apartment styling, to the premium appliances and high-end, innovative features. Everything found in the Envoy is completely exclusive, setting the benchmark for every other home in our range. The Envoy truly is a world away from anything else on the market and the ultimate investment in your leisure time.



STRUCTURAL THERMAL RATING



Rating is based on 40 x 13 - 2 when fitted with optional Ultra Warm Plus - For more information see page 5



Standard dishwasher & optional washing machine





Stamford Lodge 39 x 13 - 2

STAMFORD LODGE

From the cutting edge monochrome inspired lounge and dining space through the lavishly equipped, high gloss kitchen into the largest master suite ever found in a Carnaby, the Stamford Lodge sets new standards in exclusive lodge living.



Optional Herringbone effect fabric sofa

STRUCTURAL THERMAL RATING



Rating is based on 39 x 13 - 2 when fitted with Ultra Warm Plus - For more information see page 5





Helmsley Lodge 39 x 13 - 2

HELMSLEY LODGE

Spacious and welcoming, the warm tones of the unashamedly elegant Helmsley Lodge offer a specification and value, unrivalled by any other holiday home in this position of the market.

Filled with chic, comfortable furniture, the Helmsley Lodge is timeless and stylish, invoking impressions of quintessential lodge living. Luxury accents create a classic interior that other lodges can only aspire to imitate. Built and finished to the highest standards throughout, the wrap around kitchen and connecting dining area feature stunning high-gloss surfaces and domestic quality appliances.

Helmsley Lodge 37 x 13 - 2
& 39 x 13 - 3 seating



STRUCTURAL THERMAL RATING



Rating is based on any Helmsley Lodge when fitted with optional Ultra Warm Plus For more information see page 5



Helmsley Lodge 37 x 13 - 2 & 39 x 13 - 2

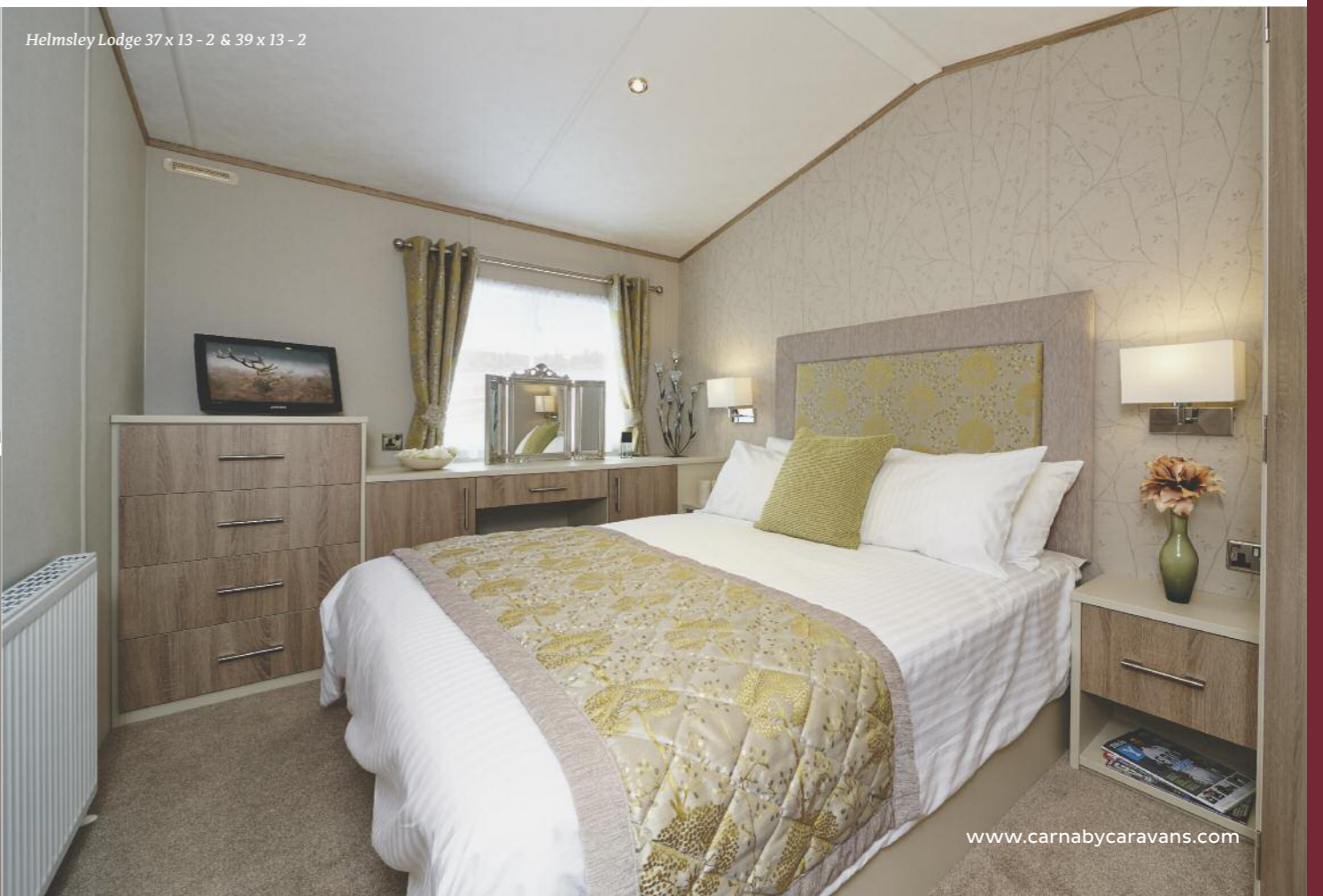

Helmsley Lodge 37 x 13 - 2 & 39 x 13 - 2



Hainsworth 39 x 12 - 2

HAINSWORTH

Sophisticated and elegant, the Hainsworth creates a contemporary, yet cosy living space.

The very latest in materials and interior design combine to produce a wonderfully modern holiday home. As easy to achieve privacy as it is to entertain guests, the Hainsworth is the pinnacle of practical meets plush.

Optional french doors



STRUCTURAL THERMAL RATING



Rating is based on 39 x 12 - 2 when fitted with optional Ultra Warm Plus - For more information see page 5





Oakdale 32 x 12 - 2

OAKDALE

Oak finishes mixed with natural colours and cream accents give rise to the Oakdale's chic and tasteful surroundings.

With modern appliances, aesthetic light fixtures and every element designed to provide maximum comfort, the Oakdale is an exemplary choice for families and couples in search of a genuine sanctuary.

Oakdale 37 x 12 - 2 optional front door & armchair layout



STRUCTURAL THERMAL RATING



Rating is based on 37 x 12 - 2 when fitted with optional Ultra Warm Plus - For more information see page 5

Oakdale 37x12-2



Oakdale 37x12-2



Oakdale 32 x 12 - 2



Oakdale 37 x 12 - 2



Oakdale 37x12-2



Oakdale 37 x 12 - 2

Oakdale 37 x 12 - 2

Oakdale 37 x 12 - 2 optional front door

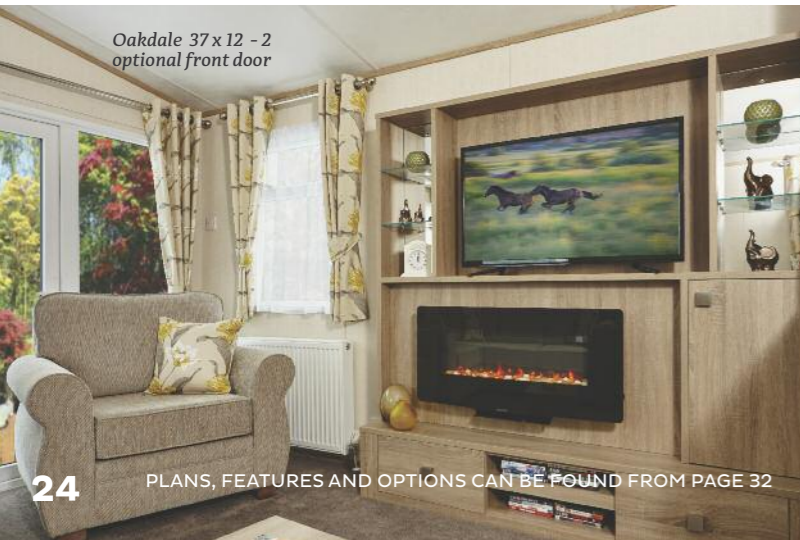

Oakdale 37 x 12 - 2



Oakdale 37 x 12 - 2





Oakdale Centre Lounge 37 x 12 - 2



37 x 12 - 2 optional extra microwave & washing machine

OAKDALE CENTRE LOUNGE

Enjoy all of the best parts of the Oakdale, blended into a unique centre lounge layout.

Perfect for families, the centrally placed lounge, kitchen and dining areas give a large open plan living space.

The clever design also separates the master bedroom from the twin bedroom(s) ensuring further privacy.

STRUCTURAL THERMAL RATING



Rating is based on 37 x 12 - 2 when fitted with optional Ultra Warm Plus - For more information see page 5





Ashdale 35 x 12 - 2

ASHDALE

Designed with lifestyle in mind, the Ashdale offers affordability without compromising on comfort and convenience.

We've created the Ashdale to make holidaying run more smoothly than ever before. Smart and clean design, matching fabrics, a space-saving dining arrangement and plenty of natural light.



STRUCTURAL THERMAL RATING



Rating is based on 36 x 12-3 when fitted with optional Ultra Warm Plus - For more information see page 5



FLOOR PLANS



Shown with optional Acadia CanExel and Grey Glazing

ENVOY

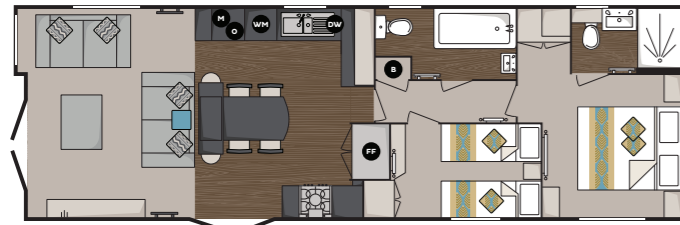

ENVOY 40 X 13 - 2 BEDROOM
Bed sizes: Double 1905mm x 1525mm & 2 x Single 1830mm x 685mm

STAMFORD LODGE

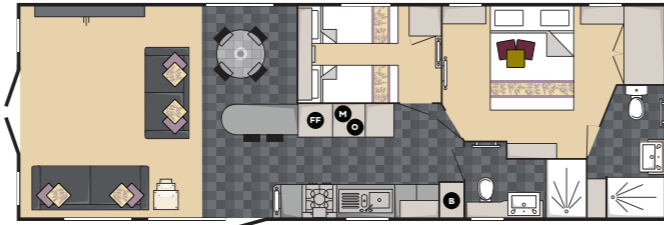

STAMFORD LODGE 39 X 13 - 2 BEDROOM
Bed sizes: Double 1905mm x 1525mm & 2 x Single 1830mm x 685mm

HELMSLEY LODGE

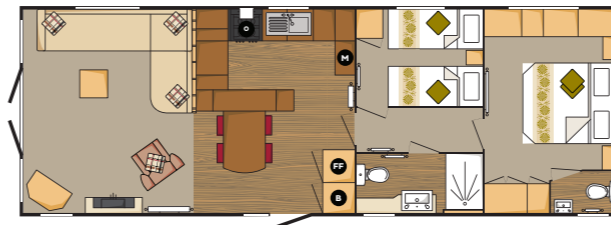

HELMSLEY LODGE 37 X 13 - 2 BEDROOM
Bed sizes: Double 1905mm x 1525mm & 2 x Single 1830mm x 760mm

HAINSWORTH

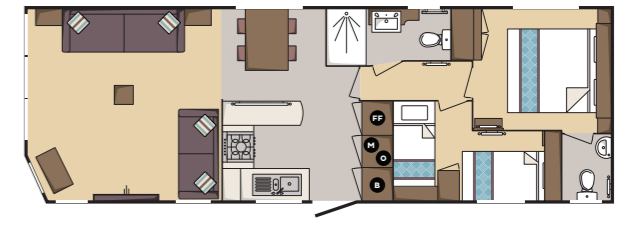

HAINSWORTH 36 X 12 - 2 BEDROOM
Bed sizes: Double 1905mm x 1525mm, 1 x Single 1830mm x 915mm & 1 x Single 1830mm x 760mm

OPTIONAL EN-SUITE LAYOUT WITH FITTED BATH

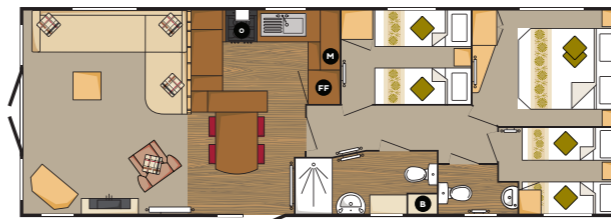

HELMSLEY LODGE 37 X 13 - 3 BEDROOM
Bed sizes: Double 1905mm x 1525mm, 2 x Single 1830mm x 685mm & 2 x Single 1830mm x 610mm

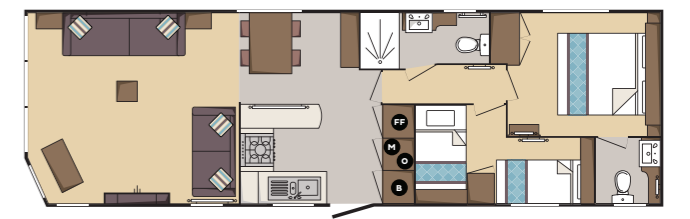

HAINSWORTH 39 X 12 - 2 BEDROOM
Bed sizes: Double 1905mm x 1525mm, 1 x Single 1830mm x 915mm & 1 x Single 1830mm x 760mm

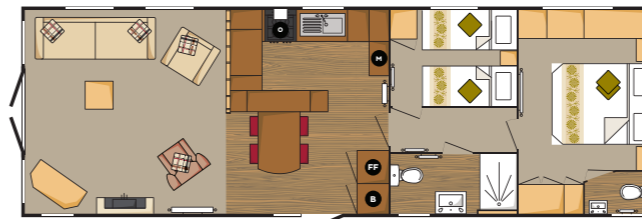

HELMSLEY LODGE 39 X 13 - 2 BEDROOM
Bed sizes: Double 1905mm x 1525mm & 2 x Single 1830mm x 760mm

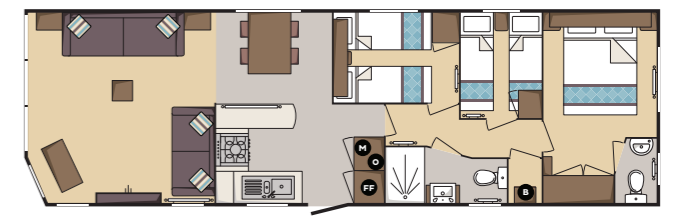

HAINSWORTH 39 X 12 - 3 BEDROOM
Bed sizes: Double 1905mm x 1370mm, 2 x Single 1830mm x 685mm & 2 x Single 1830mm x 610mm

KEY

- M**
Microwave /
Space for
Microwave
- O**
Oven
- B**
Boiler
- WM**
Optional
Washing
Machine
- DW**
Dish
Washer
- FF**
Fridge
Freezer



HELMSLEY LODGE 39 X 13 - 3 BEDROOM
Bed sizes: Double 1905mm x 1370mm, 1 x Single 1830mm x 915 mm, 1 x Single 1830mm x 760mm & 2 x Single 1830mm x 610mm

FLOOR PLANS



Shown with optional grey glazing and front door layout



OAKDALE

OAKDALE CENTRE LOUNGE

ASHDALE

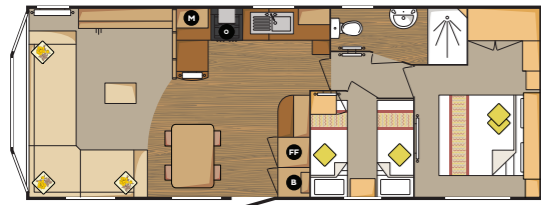

OAKDALE 32 X 12 - 2 BEDROOM

Bed sizes: Double 1905mm x 1525mm & 2 x Single 1830mm x 685mm

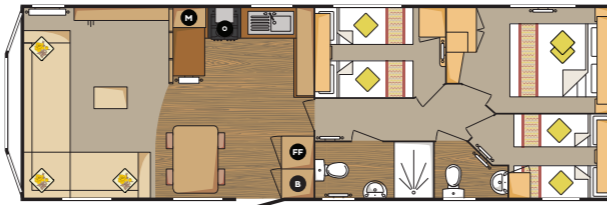

OAKDALE 36 X 12 - 3 BEDROOM

Bed sizes: Double 1905mm x 1370mm, 2 x Single 1830mm x 685mm & 2 x Single 1830mm x 610mm

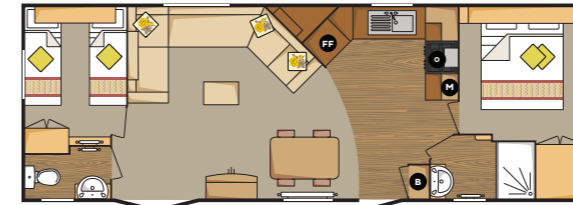

OAKDALE CL 34 X 12 - 2 BEDROOM

Bed sizes: Double 1905mm x 1525mm & 2 x Single 1830mm x 685mm

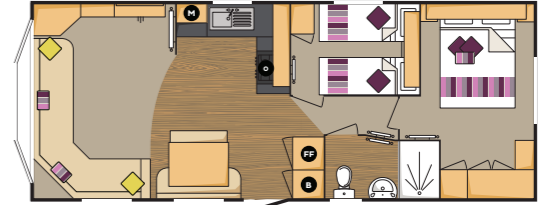

ASHDALE 30 X 12 - 2 BEDROOM

Bed sizes: Double 1905mm x 1370mm & 2 x Single 1830mm x 685mm

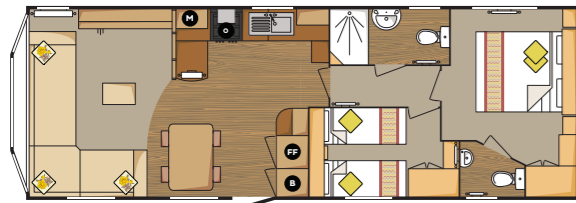

OAKDALE 35 X 12 - 2 BEDROOM

Bed sizes: Double 1905mm x 1525mm & 2 x Single 1830mm x 685mm

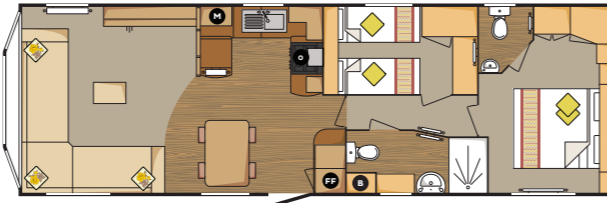

OAKDALE 37 X 12 - 2 BEDROOM

Bed sizes: Double 1905mm x 1525mm & 2 x Single 1830mm x 685mm



OAKDALE CL 37 X 12 - 2 BEDROOM

Bed sizes: Double 1905mm x 1370mm & 2 x Single 1830mm x 760mm

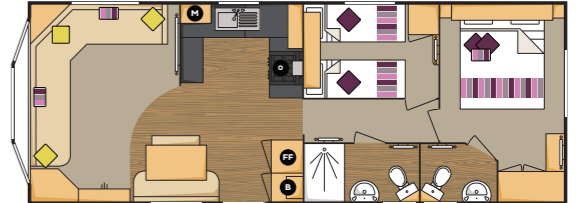

ASHDALE 32 X 12 - 2 BEDROOM

Bed sizes: Double 1905mm x 1525mm & 2 x Single 1830mm x 685mm

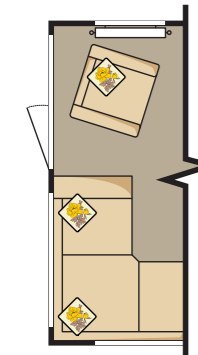

OPTIONAL FRONT DOOR SEATING ARRANGEMENT

- Oakdale 32 X 12 - 2 Bedroom
- Oakdale 35 X 12 - 2 Bedroom
- Oakdale 36 X 12 - 3 Bedroom
- Oakdale 37 X 12 - 2 Bedroom
- Oakdale 38 X 12 - 3 Bedroom

Note optional pull-out sofa bed is unavailable in the 32 x 12 - 2, 35 x 12 - 2 and the 36 x 12 - 3 with front door option fitted.

The Areobed option is available to all sizes.



OAKDALE 38 X 12 - 3 BEDROOM

Bed sizes: Double 1905mm x 1370mm, 2 x Single 1830mm x 685mm & 2 x Single 1830mm x 610mm



OAKDALE CL 37 X 12 - 3 BEDROOM

Bed sizes: Double 1905mm x 1370mm, 2 x Single 1830mm x 760mm & 2 x Single 1830mm x 685mm

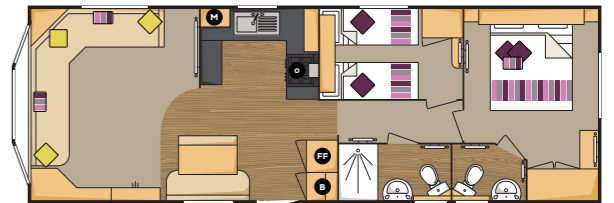

ASHDALE 35 X 12 - 2 BEDROOM

Bed sizes: Double 1905mm x 1525mm & 2 x Single 1830mm x 685mm

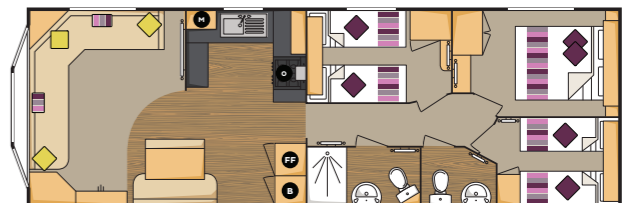

ASHDALE 36 X 12 - 3 BEDROOM

Bed sizes: Double 1905mm x 1370mm, 2 x Single 1830mm x 685mm & 2 x Single 1830mm x 610mm

EXTERNAL SIZES

KEY

- L1 Overall length including tow bar
- L2 Overall roof length inc. Gutters
- L3 Body length inc. Bay (if applicable)
- L4 Body length at floor level
- W1 Overall width inc. Gutters/Plastic front
- W2 Overall body width
- H1 Overall height inc. flues

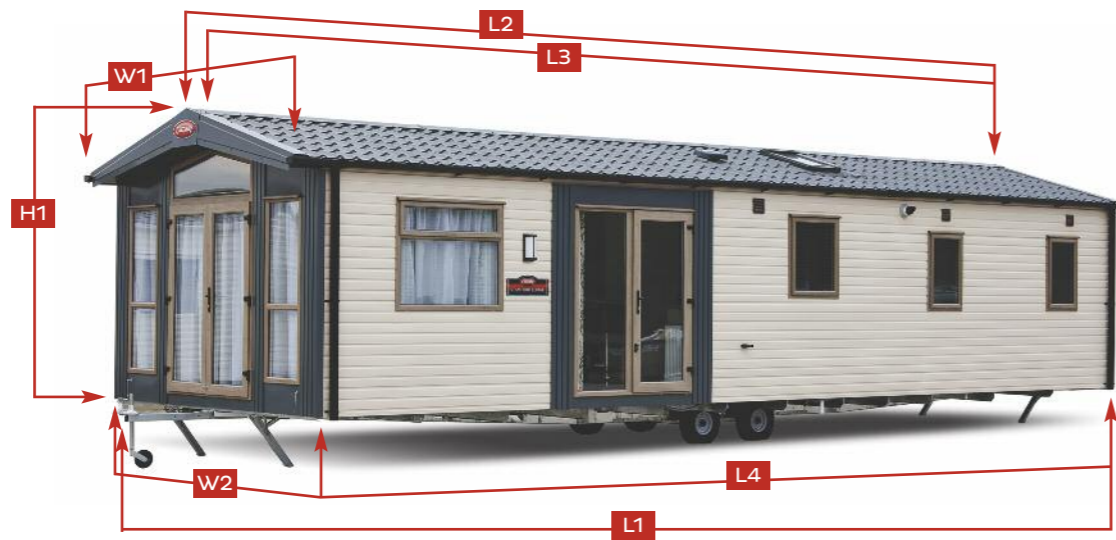

	L1	L2	L3	L4	W1	W2	H1	Weight
	(M)	(M)	(M)	(M)	(M)	(M)	(M)	(KG)
ENVOY								
40 x 13 - 2 Bedroom	13.2	12.71	N/A	12.3	4.3	3.98	3.57	6200*

STAMFORD LODGE

39 x 13 - 2 Bedroom	13	12.31	N/A	11.9	4	3.98	3.57	5590*
---------------------	----	-------	-----	------	---	------	------	-------

HELMSLEY LODGE

37 x 13 - 2 Bedroom	12.49	11.8	N/A	11.39	4.3	3.98	3.57	5420*
37 x 13 - 3 Bedroom	12.49	11.8	N/A	11.39	4.3	3.98	3.57	**
39 x 13 - 2 Bedroom	13.1	12.41	N/A	12	4.3	3.98	3.57	5880*
39 x 13 - 3 Bedroom	13.1	12.41	N/A	12	4.3	3.98	3.57	**

HAINSWORTH

36 x 12 - 2 Bedroom	11.98	11.49	N/A	11.08	4	3.68	3.47	4750*
39 x 12 - 2 Bedroom	12.79	12.3	N/A	11.89	4	3.68	3.47	5210*
39 x 12 - 3 Bedroom	12.79	12.3	N/A	11.89	4	3.68	3.47	**

OAKDALE

32 x 12 - 2 Bedroom	10.85	10.16	10.05	9.75	4	3.68	3.47	4190
35 x 12 - 2 Bedroom	11.59	10.9	10.79	10.49	4	3.68	3.47	4400
36 x 12 - 3 Bedroom	12.18	11.49	11.38	11.08	4	3.68	3.47	4370
37 x 12 - 2 Bedroom	12.49	11.8	11.69	11.39	4	3.68	3.47	4780
38 x 12 - 3 Bedroom	12.68	11.99	11.88	11.58	4	3.68	3.47	4850

OAKDALE CENTRE LOUNGE

34 x 12 - 2 Bedroom	11.58	10.68	N/A	10.48	3.88	3.68	3.47	4260
37 x 12 - 2 Bedroom	12.43	11.53	N/A	11.33	3.88	3.68	3.47	4620
37 x 12 - 3 Bedroom	12.43	11.53	N/A	11.33	3.88	3.68	3.47	**

ASHDALE

30 x 12 - 2 Bedroom	10.35	9.66	9.55	9.25	4	3.68	3.47	**
32 x 12 - 2 Bedroom	10.85	10.16	10.05	9.75	4	3.68	3.47	3780
35 x 12 - 2 Bedroom	11.77	11.08	10.97	10.67	4	3.68	3.47	3990
36 x 12 - 3 Bedroom	12.07	11.38	11.27	10.97	4	3.68	3.47	4170

* For Timber and CanExel cladding add 500Kg ** Not available at time of going to press, please check the Carnaby website or call 01262 679971 for up-to-date information. All model weights are inclusive of wet radiator heating systems. All dimensions are in metres.

EXTERIOR FINISHES



CLADDING

Exterior colours and finishes to suit you and your surroundings. Where options allow, holiday homes can be clad in Aluminium, Embossed Plastic, CanExel or Timber.

Standard	S
Optional	O
Not Available	X

STEEL

SANDSTONE		ENVIRONMENTAL	
Envoy	S	Envoy	O
Stamford	S	Stamford	O
Not Available	X	Not Available	X

ALUMINIUM

BARLEY WHITE			ENVIRONMENTAL				
Envoy	X	Hainsworth	S	Envoy	X	Hainsworth	O
Stamford	X	Oakdale/CL	S	Stamford	X	Oakdale/CL	O
Helmsley	S	Ashdale	S	Helmsley	O	Ashdale	O

EMBOSSED PLASTIC

CREAM			
Envoy	O	Hainsworth	O
Stamford	O	Oakdale/CL	O
Helmsley	O	Ashdale	O

SAND			
Envoy	O	Hainsworth	O
Stamford	O	Oakdale/CL	O
Helmsley	O	Ashdale	O

STONE			
Envoy	O	Hainsworth	O
Stamford	O	Oakdale/CL	O
Helmsley	O	Ashdale	O

ENVIRONMENTAL GREEN			
Envoy	O	Hainsworth	O
Stamford	O	Oakdale/CL	O
Helmsley	O	Ashdale	O

CANEXEL

SIERRA			
Envoy	O	Hainsworth	O
Stamford	O	Oakdale/CL	X
Helmsley	O	Ashdale	X

CLIFFSIDE			
Envoy	O	Hainsworth	O
Stamford	O	Oakdale/CL	X
Helmsley	O	Ashdale	X

ACADIA			
Envoy	O	Hainsworth	O
Stamford	O	Oakdale/CL	X
Helmsley	O	Ashdale	X

TIMBER

EUROPEAN REDWOOD			
Envoy	O	Hainsworth	O
Stamford	O	Oakdale/CL	X
Helmsley	O	Ashdale	X

WINDOW FINISHES

To complement your choice of exterior cladding colour we offer a wide range of uPVC window options.



ANTIQUÉ
(Standard on Stamford Lodge)



GOLDEN OAK



GREEN



GREY
(Standard on Envoy)

SPECIFICATION / FEATURES / OPTIONS

KEY

- Standard **S**
- Optional **O**
- Not Available **X**

EXTERIOR

	ENVOY	STAMFORD LODGE	HELMSLEY LODGE	HAINSWORTH	OAKDALE	ASHDALE
Aluminium Cladding	X	X	S	S	S	S
Steel Cladding	S	S	X	X	X	X
Plastic Cladding	O	O	O	O	O	O
CanExel Cladding	O	O	O	O	X	X
Timber Cladding	O	O	O	O	X	X
Environmental Colours (Cladding and Glazing)	O	O	O	O	O	O
Painted Chassis with Pre-Galvanised legs	X	X	X	S	S	S
Fusion Fully Galvanised Chassis	S	S	S	O	O	O
Reversible Tow Bar Facility	S	S	S	S	S	S
uPVC Double Glazing	S	S	O	O	O	O
Exterior Light	S	S	S	S	S	S
Single Front Door with Sidelight	X	X	X	X	O *1	X
French Doors	S	S	S	O	X/S *2	X
'Velux' Roof Window	S	S	O	O	O	O

HEATING & INSULATION

External Pipe Lagging	S	S	S	S	S	S
25mm Fibreglass Wall Insulation	X	X	S	S	S	S
Ultra Warm Upgrade						
• Wet System Radiators with Thermostatic Radiator Valves						
• Wall Insulation with 50mm Superglass						
• Roof Insulation 120mm Superglass with Vapour Barrier	S	S	O	O	O	O
• Floor Insulation Foiltec Double Foil						
• Glazing uPVC Double Glazed						
Ultra Warm Plus Upgrade						
• Wet System Radiators with Thermostatic Radiator Valves						
• Wall Insulation with 50mm High Density Superglass						
• Roof Insulation 100mm High Density Superglass with Vapour Barrier	O	O	O	O	O	O
• Floor Insulation Foiltec Double Foil + 25mm Superglass						
• Glazing uPVC Double Glazed 'Low E' Glass Argon filled						
Trace Heating	O	O	O	O	O	O
BS3632 Residential Specification, includes uPVC Plastic Cladding	O	O	O	X	X	X
Electric Panel Heaters	O	O	O	O	O	O

LOUNGE & DINING

	ENVOY	STAMFORD LODGE	HELMSLEY LODGE	HAINSWORTH	OAKDALE	ASHDALE
Vaulted Ceiling in Lounge Only	X	X	X	X	X/S*2	X
Vaulted Ceiling Throughout	S	S	S	S	S/X*1	S
Net Curtains/Voile on Selected Windows	S	S	S	S	S	S
Carpet Underlay	S	S	S	S	S	S
Fixed Dinette seating with Multi-Purpose Bench	X	X	X	X	X	S
Dining Table & Chairs	S	S	S	S	S	O
Additional Dining Chair	O	O	O	O	O	O
Media Hub; USB Charging Sockets in Lounge & Bedrooms	S	S	S	S	S	S
Stool	O	O	O	O	O	O
Bluetooth Lounge Ceiling Speakers	S	O	O	O	O	O
Wall Mounted TV Point (HDMI, Single Mains Socket, Aerial Co-Axial)	S	S	O	X	S*1	O
'Cosmos' Make-Up Bed in Lounge	X	X	X	X	O	O
Aerobed	O	O	O	O	O	O
Lounge Scatter Cushions	S	S	S	S	S	S
Coffee Table	X	S	S	S	S	O

KITCHEN

Externally Vented Cooker Extractor Hood	S	S	S	S	S	S
Inset 5 'Wok' Burner Gas Hob	S	S	X	S	X	X
Gas Oven & Grill (Two Door) & Four Burner Hob	X	X	S	X	S	S
Gas Oven & Grill (Two Door) & Five Burner Hob	S	S	X	X	X	X
Free-Standing Microwave Oven	X	X	X	X	O	O
Integrated Microwave Oven	S	S	S	S	O*1	O
Integrated Dishwasher	S	O	O	O	O	O
Free-Standing Fridge/Freezer	S	X	X	X	X	X
Integrated Fridge/Freezer	X	S	S	S	S	S
Plinth Lighting	S	O	O	O	O	O
Dividing Door to Hallway	S	X	S	S	S*1	O
Integrated Washing Machine	O	O	O	O	X*4	X
Integrated Washer/Dryer	O	O	O	O	X	X

BATHROOM

Extractor Fan	S	S	S	S	O	O
Family Bathroom with Bath	S	X	X	X	X	X
En-Suite Bathroom with Bath	X	O	X	X	X	X
Family Bathroom with Shower	X	S	S	S	S	S
En-Suite Bathroom with Shower	S	S	X	X	X	X

BEDROOM

Bedding Set (Duvet Covers, Pillow Cases & Runners)	S	O	O	O	O	O
Tuftained Mattress (Single)	O	O	O	O	O	O
Tuftained Mattress (Double)	O	O	O	O	O	O
Gas Strut Lift-Up Storage Bed (Main Bedroom Only)	S	S	S	O	O	O
Space Saving Fold Under Bed (Twin Rooms Only)	O	O	O	O*3	O	O
Mosquito Nets & Blinds	O	O	O	O	O	O
TV Ariel Booster	S	O	O	O	O	O
TV Point in Main Bedroom	S	S	S	S	O	O
TV Point in Twin Bedroom	S	S	O	O	O	O
TV Point in Third Bedroom	X	X	O	O	O	O

*1) Not available on Oakdale Centre Lounge *2) Standard on Oakdale Centre Lounge model, not available on standard Oakdale *3) Three bedroom model only. *4) Except 37 x 12 - 2 Oakdale Centre Lounge



HOLIDAY HOMES OF DISTINCTION
2017 COLLECTION
DEALER / PARK OPERATOR STAMP



Table settings, ornaments, toys, electrical appliances, duvet covers and pillowcases as displayed are intended for photographic purposes only and, unless otherwise specified in writing, do not form any part of any contract, nor do they constitute any representation whatsoever by us or on behalf of Carnaby Caravans Ltd. All dimensions are approximate sizes. Carnaby reserves the right to change any materials, fittings etc, shown in this brochure without prior notice in accordance with our policy of continual improvement or availability of material. All Carnaby holiday homes are built to grades A & B snow-loading in accordance with EN1647. The model designate does not denote the body length or width. All Carnaby holiday homes must be connected to mains water, sewerage, electricity, and propane gas (unless otherwise specified).

Caravan holiday homes are designed to provide comfortable, high-quality accommodation for holiday and recreational use only; recreational use should be considered to include holidays of not more than six weeks of continuous use, weekend visits, and other short duration visits, they are not designed for residential occupancy. Caravan holiday homes are built to the EN 1647 specification. If you are looking to live in a caravan holiday home or stay in one for non-recreational use you should consider purchasing a residential park home which is sited on a residential park home estate. If the above advice is not followed and your caravan holiday home is used as a main residence then the manufacturer's warranty may be compromised.

The Envoy, Stamford Lodge and Helmsley Lodge are as an optional extra available in BS3632 which has the advantage of 0% VAT on the construction element. Please refer to the Park Licence and associated planning conditions when selecting either a holiday home EN1647 or a BS3632 residential specification unit.

PLEASE ASK YOUR DEALER OR PARK TO CONFIRM PRICES

For further product information please call 01262 679971 or
for general enquiries email: info@carnabycaravans.com,
for sales enquiries email: sales@carnabycaravans.com
or visit our website.



CARNABY CARAVANS LIMITED

Lancaster Road, Carnaby Industrial Estate, Bridlington,
East Riding of Yorkshire YO15 3QY

Tel: 01262 679971 Fax: 01262 670315

www.carnabycaravans.com

